

# sustaining

effective practices for student outcomes



Missouri Schoolwide Positive Behavior Support

# summer training institute

June 10-12, 2015 • Tan-Tar-A Resort, Osage Beach, Mo.

# Table of Contents

Welcome from the Commissioner of Education .....	1
Conference Agenda.....	2
Presenters .....	3
Sessions.....	4-13
School Recognition Awards.....	14-17
Leadership Team Action Planning Worksheet.....	18
MO SW-PBS Team.....	19
Notes .....	20
Facility Layout.....	21

**Name Badge Required  
for Admittance to Meals/Sessions**



## Save the Date

Missouri Schoolwide  
Positive Behavior Support  
2016 Summer Training Institute

Sunday, June 12 – Tuesday, June 14, 2016  
Tan-Tar-A Resort • Osage Beach, Mo.

# Welcome



Margaret M. Vandeven, Ph.D. • Commissioner of Education

205 Jefferson Street, P.O. Box 480 • Jefferson City, MO 65102-0480 • [dese.mo.gov](http://dese.mo.gov)

June 2015

Dear Summer Training Institute Participants:

Welcome to the 2015 Missouri Schoolwide Positive Behavior Support (SW-PBS) Summer Training Institute. This year's theme, *Sustaining Effective Practices for Student Outcomes*, reinforces the importance of sustaining implementation of research-based practices in light of administrative, faculty, staff and student turnover.

The Training Institute sessions emphasize building sustainable school systems to support the academic and social behavioral achievement of all students throughout their school career. Strands focus on ways to address the challenges that schools face when implementing and sustaining multiple initiatives. Topics include: Leadership; Effective Classroom Practices; Data, Technology & Innovation; Student Voice; Family & Community; and Equity.

I hope you find the sessions meaningful and informative and have a successful training institute experience in which you gain research-based instructional skills to promote maximum student learning.

On behalf of the Missouri State Board of Education and the Department of Elementary and Secondary Education, I want to express our appreciation for your exceptional work with Missouri's students.

I look forward to working with you to achieve our Top 10 by 20 goal.

Sincerely,

A handwritten signature in black ink that reads "Margie Vandeven". The signature is written in a cursive, flowing style.

Margie Vandeven  
Commissioner of Education

# Conference Agenda

## Tuesday, June 9

6:00 – 9:00 p.m.      **Registration** (*Salon Foyer*)

## Wednesday, June 10

8:30 a.m. – 5:00 p.m.      **Registration** (*Salon Foyer*)

1:00 – 1:45 p.m.      **Welcome and Opening Remarks** (*Salons A-C*)  
Dr. Tim Lewis

2:00 – 3:15 p.m.      **Regional Time and Recognitions with Regional Directors**  
Central (*Parasol I*)                                  South Central (*Crystal Ballroom*)  
Heart of Missouri (*Northwinds*)                  Southeast (*Windgate Hall*)  
Kansas City (*Rooms 60-61*)                          Southwest (*Rooms 62-64*)  
Northeast (*Rooms 74-75*)                              Special School District (*Rooms 70-71*)  
Northwest (*Rooms 72-73*)                              Education Plus (*Suite G*)

3:30 – 4:45 p.m.      **Breakout Session 1**

5:00 – 6:00 p.m.      **Poster, Web and Video Session** (*Salon C*)

## Thursday, June 11

7:00 – 7:45 a.m.      **Continental Breakfast** (*Windgate Hall*)

8:00 – 8:45 a.m.      **Keynote Address** (*Salons A-C*)  
Dr. Kent McIntosh  
“Enhancing Sustainability for Improved Student Outcomes”

9:00 – 10:15 a.m.      **Breakout Session 2**

10:30 a.m. – 11:45 a.m.      **Breakout Session 3**

11:45 a.m. – 1:00 p.m.      **Lunch and Team Time** (*Windgate Hall*)

1:15 – 2:30 p.m.      **Breakout Session 4**

2:45 – 4:00 p.m.      **Breakout Session 5**

4:15 – 5:30 p.m.      **Round Table Guided Networking**

8:00 - 11:00 p.m.      **Evening Social with Karaoke** (*Crystal Ballroom*)

## Friday, June 12

7:00 – 7:45 a.m.      **Breakfast Buffet** (*Windgate Hall*)

8:00 – 9:15 a.m.      **Breakout Session 6**

9:30 – 10:45 a.m.      **Breakout Session 7**

11:00 a.m. – 12:15 p.m.      **Team Time**  
Central (*Parasol I*)                                  South Central (*Crystal Ballroom*)  
Heart of Missouri (*Northwinds*)                  Southeast (*Parasol II*)  
Kansas City (*Rooms 60-61*)                          Southwest (*Rooms 62-64*)  
Northeast (*Rooms 74-75*)                              Special School District (*Rooms 70-71*)  
Northwest (*Rooms 72-73*)                              Education Plus (*Suite G*)

# Presenters

**Dr. Tim Lewis** has been involved in special education for 30 years. He has taught students with emotional and behavioral disorders in high school, elementary and self-contained psychiatric settings. At present, Lewis is professor of special education at the University of Missouri. He is the associate editor of the *Journal of Positive Behavior Interventions* and is a member of 13 other editorial boards. Lewis has been involved with developing schoolwide systems of behavioral support for over 20 years. He directs the University of Missouri Center for Schoolwide Positive Behavior Support, is co-director of the national OSEP Center for Positive Behavioral Interventions and Supports and the IES Center for Adolescent Research in Schools.

**Dr. Kent McIntosh** is an associate professor at the University of Oregon's College of Education. His current research focuses on implementation and sustainability of school-based interventions, reducing discipline disparities, and integrated academic and behavior support. He is lead author of over 50 publications. He is co-investigator on the OSEP National Technical Assistance Center on PBIS and lead of the Center's Disproportionality Workgroup. He also has worked as a school psychologist, teacher-trainer and teacher in both general and special education.

**Dr. Jennifer Freeman** is an assistant professor in the Department of Educational Psychology and is a research scientist for the Center for Behavioral Education Research (CBER) at the University of Connecticut. Freeman studies the effects of multi-tiered systems of support such as positive behavior interventions and supports (PBIS) on outcomes at the high-school level for high-risk student groups, including students with disabilities. She currently teaches undergraduate courses in the special education program. Freeman also has 10 years of special education teaching experience across grades K-8 in both urban and rural school settings and served as a K-12 district-level consultant working to implement PBIS and response to intervention (RtI) strategies.

**Dr. Kelsey Morris** is a research faculty member at the University of Oregon and the director of Training and Communications for Educational and Community Supports, a research unit within the College of Education. Prior to coming to the University of Oregon, Morris served as a school administrator at the elementary level and also assisted with district coordination of PBIS for Columbia Public Schools in Columbia, Mo. His professional focus is working with school/facility/district teams on using data for decision-making.

## 2014 SW-PBS Summer Training Institute

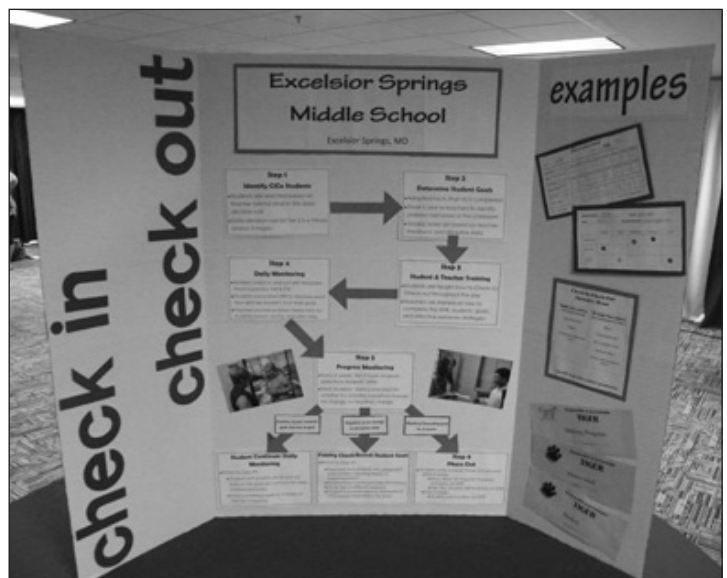
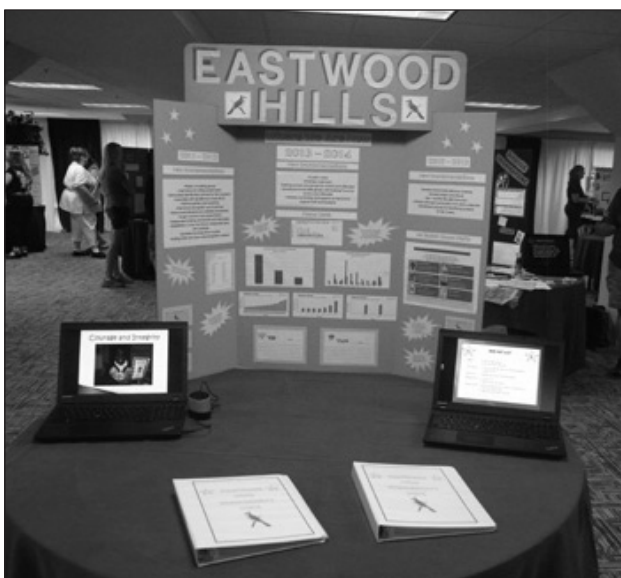

# Sessions

## **BREAKOUT SESSION 1** **June 10 • 3:30 – 4:45 p.m.**

### **1A: SW-PBS Basics for New Team Members**

#### **Tier 1 – Foundation** (*Rooms 62-64*)

This session for administrators, coaches and team members who are new to MO SW-PBS will provide an overview of the essential components of SW-PBS: common philosophy and purpose, leadership, clarifying expected behavior, teaching expected behavior, encouraging expected behavior, discouraging inappropriate behavior, ongoing monitoring and classroom effective practices.

**Presenters:** Jill Miller, MO SW-PBS Consultant, Northeast Region, Truman University; Karen Wigger, MO SW-PBS Consultant, Northwest Region, Northwest Missouri State University

### **1B: Responding to Inappropriate Behavior**

#### **Tiers 1, 2, 3 – Foundation** (*Salon A*)

Discover how all staff can respond effectively to inappropriate student behaviors and how to implement cost-benefit strategies such as card or clip systems and newer technology-based tools such as Classroom Dojo.

**Presenter:** Dr. Tim Lewis, Director MU PBS Center, Co-Director, PBIS National Center

### **1C: Transfer Student Induction Within the SW-PBS Framework** (*Parasol II*)

#### **Tiers 1, 2, 3 – Enrichment**

A comprehensive induction system can support new students while strengthening and supporting schoolwide practices and initiatives such as positive behavior supports or response to intervention. Hear about a proactive process that assures fidelity and relationship building during the student-induction process. Learn necessary structures to consider when developing and implementing an induction program within the PBIS framework and receive multiple tools useful for planning, implementation and progress monitoring.

**Presenters:** Chris Hubbuch, Principal; Keelie Stucker, Assistant Principal, Excelsior Springs Middle School; and Molly Kuebler, Intervention Coach, Excelsior Springs School District; Diane Feeley, Tier 2-3 Consultant, MO SW-PBS

### **1D: Super Cubs to the Rescue! How to Use Video Modeling to Teach SW-PBS Expectations in Early Childhood** (*Redbud*)

#### **Tier 1 – Application**

As part of Tier 1 schoolwide implementation, the Gerner Center created videos to teach each of the Super Cub Expectations to Be Ready, Be Safe and Make Good Choices in a variety of settings including: playground, hallways, restroom, multipurpose room and bus. Learn how to incorporate video modeling in Tier 1 SW-PBS implementation at the early childhood level in engaging and developmentally appropriate ways for students at all levels.

**Presenters:** Dr. Angela Currey, Principal; Irene Keller, School Psychologist; Elisa Parker, Autism Consultant and Assistive Technology Specialist; and Terrann Wood, Tuition Preschool Teacher; Gerner Family Early Education Center; Erin Klein, Regional SW-PBS Consultant, Kansas City Region, University of Missouri

### **1E: P.A.W.S. (Positive Attitudes Will Succeed) – Incentive Systems to Achieve Success** (*Northwinds*)

#### **Tier 1 – Application**

Discover how to build incentives into the schoolwide PBIS matrix and gain a greater understanding of the use of positives (4 to 1) in all areas (not just classroom) to instill goal setting for both the individual student and collectively schoolwide. Discussion will include making use of lunchtime for social skills lessons, positive promotions for teachers to use the BARK buck system (our schoolwide free and frequent ticket system), creative awards to motivate academic and social success and free schoolwide celebrations that students love.

**Presenters:** Kathryn Lehnen, Teacher; Early Childhood Center; Rebecca Blair, Teacher, Hawthorne Elementary School; Mexico 59 School District; Amanda Holloway, Regional SW-PBS Consultant, Heart of Missouri Region, University of Missouri

### **1F: Using SW-PBS End-of-Year Reports to Set and Achieve Annual SW-PBS School Improvement Goals** (*Rooms 60-61*)

#### **Tiers 1, 2, 3 – Application**

This hands-on workshop will use your school's MO SW-PBS End-of-Year Report to establish goals and an action plan for the coming school year. Obtain a copy of your End-of-Year Report for 2014-2015 from your regional SW-PBS consultant to bring, as well as

other relevant summative SW-PBS data. School teams are encouraged to attend as you will review your data and begin initial planning.

**Presenter:** Dr. Gordon Way, Data/Web Consultant, MO SW-PBS

### **1G: Using a Schoolwide Universal Screening Process to Identify At-Risk Students** (*Crystal Ballroom*)

#### **Tiers 2, 3 – Application**

A systematic identification process at Tier 2 should include a minimum of two data sources to accurately identify students with internalizing and/or externalizing social, emotional or behavioral risk factors. Learn to use a standardized screening instrument as one data source. Universal screening provides an opportunity for all students to be considered for risk factors against identified criteria. Hear about the research behind universal screening, standardized screening instrument options, benefits of using universal screening and how it fits into a Tier 2 and Tier 3 identification process.

**Presenters:** Danielle Starkey, Tier 2-3 Consultant, MO SW-PBS; Dr. Stephen Kilgus, Assistant Professor, and Crystal Taylor, Doctoral Student; School Psychology Department, University of Missouri

### **1H: Utilizing Technology in Tier 3 Data Collection**

(*Parasol I*)

#### **Tier 3 – Application**

Discover the newest applications available to make data collection at Tier 3 a breeze! The applications reviewed will aid your Tier 3 team in collecting frequency, duration and interval data to inform the outcome measures on your Behavior Intervention Plan. *\*Note – some of the applications presented include a small fee if interested in purchasing.*

**Presenter:** Karin Leveke, Tier 2-3 Consultant, MO SW-PBS

### **1I: Comprehensive Integrated Three-Tiered Model of Prevention and Intervention – Integrating RtI and SW-PBS** (*Rooms 74-76*)

#### **Tiers 1, 2, 3 – Application**

Address academic, behavioral and social domains in tandem through a comprehensive, integrated three-tiered (CI3T) model of prevention. As part of this integrated approach, screening and assessment systems are put in place to support early detection efforts across the pre-K through 12th grade continuum as well as accurate assessment of student performance over time. Learn a system for proactively responding to identified students' needs to increase academic, behavioral and social success.

**Presenter:** Dr. Lisa Powers, Area Coordinator, Special School District of St. Louis County

## **BREAKOUT SESSION 2**

**June 11 • 9:00 – 10:15 a.m.**

### **2A: Translating Knowledge into Practice: Teaching Teachers to Use Self Management to Improve Classroom Management Practices** (*Salon A*)

#### **Tiers 1, 2, 3 – Application**

Hear about recent research on supporting teachers' classwide SW-PBS practices and learn self-management strategies to improve implementation. Receive tools and an opportunity to practice developing a self-management plan.

**Presenter:** Dr. Jennifer Freeman, Assistant Professor, Department of Educational Psychology, University of Connecticut

### **2B: Process of Observations to Drive Effective Classroom Practices Implementation** (*Suite G*)

#### **Tiers 1, 2, 3 – Application**

Effective practices within the classroom is a critical component of SW-PBS implementation. The fidelity of these classroom systems serve as a predictor of sustainability and student outcomes with the strongest predictors being regular acknowledgement of appropriate student behaviors, matching instruction with student ability and having access to additional support. Learn about a sample observation protocol that was used to provide ongoing monitoring of classroom practices and as a data-decision tool to guide staff coaching.

**Presenters:** Daniel Rector, Assistant Principal; Hilary Myers and Hilary Trammell, Teachers; West Middle School, Columbia 93 School District; Sarah Moore, Research Assistant, MU Center for PBS, University of Missouri

### **2C: Utilizing Positive Specific Feedback Across all Three Tiers** (*Northwinds*)

#### **Tiers 1, 2, 3 – Application**

Specific positive feedback by teachers is a critical piece of SW-PBS implementation at Tiers 1-3. Effective specific positive feedback consists of: stating the expectation, specifically describing the behavior and can include a positive consequence. Research recommends a ratio of 4:1; four comments in response to desired student behavior to one response to student misbehavior. Learn how to establish and sustain staff use of specific positive feedback at a ratio of at least 4:1 across Tiers 1-3. Receive a guide with examples of specific positive feedback, frequently asked questions and self-monitoring strategies to increase this practice in every classroom from the first day of school.

**Presenters:** Danielle Starkey and Deanna Maynard, Tier 2-3 Consultants, MO SW-PBS

## **2D: Tier 1.5. and Beyond** (*Redbud*)

### **Tiers 1, 2 – Enrichment**

Learn how one school discovered that by placing an intentional, focused effort on students who meet “at-risk” requirements, students who met Tier 2/3 criteria in years past, or students who are beginning to spike, they are frequently successful in thwarting students from reaching Tier 2. This concerted effort was jokingly called Tier 1.5, and the name stuck. Learn about highly effective home visit strategies, PBS 101 for students program and the various ways to engage your entire school community in early behavior prevention efforts, including how to deal with reluctant staff members.

**Presenters:** Jennifer L. Jorel and Suzan M. Wilson, Teachers; Saeger Middle School, Francis Howell R-III School District; Karen Westhoff, Regional SW-PBS Consultant, St. Louis RPDC, Education Plus; Deb Childs, Tier 2-3 Consultant, MO SW-PBS

## **2E: Tier 2 Overview and Readiness** (*Rooms 62-64*)

### **Tier 2 – Foundation**

What are the key features of Tier 2? Does your school have everything in place for the development of Tier 2 systems, data and practices? How will you know if you’re ready? Learn to identify key features of a Tier 2 system, characteristics of maximally effective interventions and how to determine readiness for development of Tier 2.

**Presenter:** Diane Feeley, Tier 2-3 Consultant, MO SW-PBS

## **2F: Student Intervention Team (Tier 2)**

### **Implementation and Maintenance** (*Crystal Ballroom*)

#### **Tier 2 – Application**

The SIT team at Boswell Elementary School has 10+ years experience. Their current goals are to provide improved ways to continue this work while bringing new staff members along. Learn how to implement, organize and sustain a Tier 2 team at the intermediate elementary level.

**Presenters:** Jamie Goforth, Assistant Principal; Carla Mobley, Tier 2 Coach; Jalana Kinde, Tier 2 Representative; Boswell Elementary School, Lebanon R-III School District; Jo Ann Anderson, Tier 2-3 Consultant, MO SW-PBS

## **2G: Establishing a Common Purpose, Ownership and Common Expectations** (*Parasol I*)

### **Tiers 1, 2, 3 – Application**

Building principals of five elementary buildings discuss their journey within the district to establish and maintain a common purpose of a student-centered learning environment. Understand the role

the administrator takes within a SW-PBS school and learn steps to create and maintain a core SW-PBS team charged with the responsibility of identifying and communicating the “why” of what we do and clarifying common expectations. A model of establishing a district-level school positive behavior support leadership team to increase support, visibility and implementation will be shared.

**Presenters:** Dr. Lance McClard, Principal, North Elementary School; Shauna Criddle, Principal, Gordanville Elementary School; Dr. Jessica Maxwell, Principal, South Elementary School; Samantha Trankler, Principal and Krista Birk, Assistant Principal, West Lane Elementary School; Shanna Wilson, Principal, Orchard Drive Elementary School; Jackson R-II School District; Cynthia Matthew, Regional SW-PBS Consultant, Southeast RPDC

## **2H: ISIS-SWIS** (*Parasol II*)

### **Tier 3 – Foundation**

Learn about ISIS-SWIS, a decision system for students receiving more intensive supports for academic, social or mental health services. Using ISIS-SWIS can define data-collection measures, upload and store documentation, and summarize data for decision making. *\*Note ISIS-SWIS is a fee-based online system and is part of the SWIS Suite.*

**Presenter:** Dr. Kelsey Morris, Senior Research Assistant, PBISApps, University of Oregon

## **2I: Trauma, Self-Regulation and School**

### **Problems: Teaching Traumatized and Emotionally Dysregulated Students** (*Salon C*)

#### **Tiers 1, 2, 3 – Foundation**

Adverse childhood events are much more prevalent and have a much greater impact on educational achievement and classroom behaviors than previously realized. Traditional classroom behavior management strategies are often not only ineffective but counterproductive with students who have experienced relational traumas. Understand the widespread prevalence of adverse childhood events, their impact on the developing brain and the resulting impact on educational performance and classroom behaviors.

**Presenter:** Gerald Cox, Licensed Clinical Psychologist

## **2J: The D.R.A.F.T. (Developing Relationships and Focused Teaching)** (*Rooms 60-61*)

### **Tier 2 – Application**

The D.R.A.F.T. is a program intended to increase rigor and relevance in the classroom and improve the culture and climate of the school through meaningful



relationships. Teachers “draft” students for specific interventions based on student needs and teacher strengths for a 30-minute period built into the school day. Focus is on academic and social/emotional needs, allowing for tailoring of interventions. PLC time stresses collaboration, communication and early interventions to ensure that no student falls through the cracks.

**Presenters:** Brian Moler, Assistant Principal; John Kessinger and Matt Locke, Teachers; Reed Springs High School, Reed Springs R-IV School District; Betty Ennis, Tier 2-3 Consultant, MO SW-PBS

## **BREAKOUT SESSION 3**

**June 11 • 10:30 – 11:45 a.m.**

**3A: Translating Knowledge into Practice: Teaching Teachers to Use Self Management to Improve Classroom Management Practices** (*Salon B*)

**Tiers 1, 2, 3 – Application**

Repeat of Session 2A

**3B: Student Voice in Action** (*Redbud*)

**Tier 1 – Enrichment**

Hear an overview of how class meetings can provide avenues for students to be actively involved in the development of schoolwide rules and expectations. Receive a brief overview of the class meeting structure along with how one school utilizes this structure to get all students involved in the development of their schoolwide expectations and rules.

**Presenters:** Karen Westhoff, Regional SW-PBS Consultant, St. Louis RPDC, Education Plus; Diane Stirling, Character Plus Consultant, Education Plus; Heather Bitter, Teacher; Henderson Elementary School, Francis Howell R-III School District

**3C: Student Voice, Recognition and Leadership...Oh My!** (*Crystal Ballroom*)

**Tier 1 – Application**

Hear about one school’s unique way to incorporate student voice, recognition and leadership into the daily life of every student. Learn how student leadership has increased buy-in as well as allowing greater consistency. Their recognition systems and school store system will also be shared.

**Presenters:** Larissa Cutsinger, General Music/SW-PBS Coach; Student Leaders; Waynesville Sixth Grade Center, Waynesville R-VI School District; Jo Ann Anderson, Tier 2-3 Consultant, MO SW-PBS

**3D: It’s Not Always About the Destination, It’s the Journey – “Don’t Stop Believing!”** (*Suite G*)

**Tiers 1, 2 – Application**

Sustaining an initiative can be overwhelming. Don’t reinvent the wheel. Be prepared to “not stop believing” the SW-PBS philosophy will happen for your school. Learn the overall SW-PBS philosophy from beginning implementation to sustaining Tier 2 and beyond, how to get all stakeholders involved, and how to implement and fund token economy (School Birdhouse Store), teacher incentives, SW-PBS Tier I schoolwide expectations and lesson plans for social groups.

**Presenters:** Sarah Gerving, Principal; Becky Barry, Teacher and Tier 1 Coach; Jenny Goss, Teacher and Tier II Coach; Angie Losson, Librarian and Check-in Check-Out Data; Pickett Elementary School, St. Joseph School District; Karen Wigger, Regional SW-PBS Consultant, Northwest RPDC

**3E: Super Socials: Super Way of Promoting Super Behavior** (*Salon A*)

**Tiers 1, 2, 3 – Application**

Receive a timeline of how the Super Socials have evolved from a reward-only activity focusing on three levels of reward time to the appropriate behavior-practicing, hands-on learning activity that they are today. Discover the reasoning that was involved leading to the current form of Super Socials celebrated today. The various types of community involvement will be discussed as well as the process to get volunteers. Pre-Event instructional videos and photos of all the fun will also be shared. Leave with ideas for your own student celebrations.

**Presenters:** Christine Brines, PBIS Coordinator and Teacher; Neosho Middle School; Courtney McFarland, Behavioral Specialist; Neosho R-V School District; Susanna Hill, Tier 2-3 Consultant, MO SW-PBS

**3F: Putting a Human Face on the Numbers: Identifying and Addressing Disproportionality in School Discipline** (*Parasol II*)

**Tiers 1, 2, 3 – Application**

Learn how to use data to identify and monitor potential disproportionality in office referrals and resulting consequences that may perpetuate a cycle of absenteeism, detachment, academic failure and dropout. Receive strategies for ensuring that all students are treated fairly regardless of race, ethnicity, gender, sexual orientation or IEP status.

**Presenters:** Dr. Gordon Way, Data/Web Consultant and Dr. Jimmie Bullard, Tier 2-3 Consultant, MO SW-PBS

### **3G: The Administrator's Role in SW-PBS**

*(Rooms 60-61)*

#### **Tier 1 – Foundation**

Successful school improvement efforts all share one commonality – strong leadership. Designed for administrators who are new to a SW-PBS building, this session will review the eight essential components of MO SW-PBS and define the role of the administrator in development and implementation.

**Presenters:** Christopher Schmitz, Principal, Thorpe Gordon Elementary School, Jefferson City Public Schools; Amanda Holloway, Regional SW-PBS Consultant, Heart of Missouri RPDC

### **3H: Tier 3 Overview and Readiness** *(Rooms 62-64)*

#### **Tier 3 – Foundation**

What are the key features of Tier 3? Does your school have everything in place for the development of Tier 3 systems, data and practices? How will you know if you're ready? Learn to identify key features of a Tier 3 system, characteristics of maximally effective interventions and how to determine readiness for development of Tier 3.

**Presenter:** Diane Feeley, Tier 2-3 Consultant, MO SW-PBS

### **3I: Becoming a Trauma-Informed School** *(Salon C)*

#### **Tiers 1, 2, 3 – Foundation**

Research shows that a large percentage of children across our nation are victims of traumatic stress. In addition to affecting children's emotional well-being and interpersonal relationships, childhood trauma has been shown to have a significant impact on their capacity to learn. While staff training and a major paradigm shift in school disciplinary policies and thinking about children's misbehaviors have been necessary, school districts are learning ways to counteract the toxic impact childhood trauma is having on learning. Learn more about the relationship between trauma and learning problems as well as how to become a trauma-informed school.

**Presenter:** Gerald Cox, Licensed Clinical Psychologist

## **BREAKOUT SESSION 4**

**June 11 • 1:15 – 2:30 p.m.**

### **4A: Equity and SW-PBS Part 1: Using Discipline Data to Assess and Address Disproportionality** *(Salon C)*

#### **Tiers 1, 2, 3 – Application**

The first of a two-part session will walk participants through their discipline data and a structured process of using it to identify equity challenges and understand why they are happening.

**Presenter:** Dr. Kent McIntosh, Associate Professor, College of Education, University of Oregon

### **4B: Strengthening SW-PBS with Student Teams**

*(Suite G)*

#### **Tier 1 – Application**

Learn how to unleash the power of student leadership to strengthen SW-PBS practices. Honoring student voice and empowering student leadership are powerful ways to teach and encourage expected behaviors, improve school climate and prevent bullying. Hear one school's student team share their journey and describe how they develop SW-PBS lessons and videos for their middle school. Students will outline the planning process for incentives and celebrations held at school and describe their role as student ambassadors in the transfer student induction process. Receive resources and action steps to help with implementation in the fall.

**Presenters:** Molly Kuebler, Intervention Coach; Student Leadership Team; Excelsior Springs Middle School, Excelsior Springs 40 School District; Diane Feeley, Tier 2-3 Consultant, MO SW-PBS

### **4C: Monitoring Implementation of Effective Classroom Practices** *(Northwinds)*

#### **Tiers 1, 2, 3 – Application**

Learn the processes used in one elementary school to monitor effective classroom practices, including the adjustments that have been made to the processes over time. Leave with a plan to monitor routine implementation of MO SW-PBS effective classroom practices.

**Presenters:** Joseph Moore, Teacher; Leanna Isaac, Counselor; North Elementary School, Jackson R-II School District; Cynthia Matthew, Regional SW-PBS Consultant, Southeast RPDC

### **4D: The Wildcat Way – A Preschool Approach to SW-PBS** *(Redbud)*

#### **Tier 1 – Application**

Receive an overview of Field Early Childhood Center's SW-PBS program as well as their system for training new staff. Ideas for unconventional monthly training and data meetings will be shared. Learn how to use staff recognition and monthly incentives to foster a positive school climate as well as encourage staff buy-in. The ideas presented are appropriate for anyone who wants to bring new ideas to their SW-PBS program.

**Presenters:** Tiffany Hoerning, Brandi Ensor and Amanda Ohlhausen, Teachers; Dr Trish Wilson, Director; Field Early Childhood Center, Neosho R-V School District; Susanna Hill, Tier 2-3 Consultant, MO SW-PBS

#### **4E: Release the Creativity with App Smashing**

*(Crystal Ballroom)*

##### **Tiers 1, 2, 3 – Enrichment**

What is App Smashing? Creating content in one app, transferred into another app and sometimes a third app! App Smashing allows for the learning opportunities we want in our classrooms – creativity, collaboration, critical thinking and problem solving. App Smashing provides students with choice and helps level task difficulty. You don't have to rely on a single app to meet your students learning objectives – **get smashing!**

**Presenters:** Jo Ann Anderson, Tier 2-3 Consultant, MO SW-PBS; Diane Grep, Technology Director, South Central RPDC

#### **4F: One Approach to Administrator Support for SW-PBS Implementation** *(Rooms 60-61)*

##### **Tier 1 – Application**

The literature is clear about the importance of administrator leadership to address critical school needs, structures for continuous improvement, school culture and effective team development. Review the critical importance of administrative support and SW-PBS implementation. An example of developing and structuring an efficient SW-PBS team that is representative of school staff, is focused on school improvement through data-decision processes as well as on transparency and inclusion of stakeholder voice will also be shared.

**Presenters:** Daniel Rector, Assistant Principal, West Middle School, Columbia 93 School District; Linda Bradley, Research Assistant, MU Center for PBS, University of Missouri

#### **4G: Checking In on Check-In, Check-Out** *(Salon B)*

##### **Tier 2 – Foundation**

Learn the nuts and bolts of the Tier 2 intervention called Check-In, Check-Out (CICO) and how to make it work in the real world called “your school.”

**Presenter:** Heather Barnes, Teacher; and Susan Long, 6th Grade Principal; Sikeston 5th & 6th Grade Center Debbie Lintner, Tier 2-3 Consultant, MO SW-PBS

#### **4H: Teaching Social Skills: The Cornerstone of Schoolwide PBS** *(Salon A)*

##### **Tiers 1, 2 – Application**

Discover essential features of creating social-skill lesson plans and teaching strategies from universal to individual behavior plans. Examples from a middle school will be shared. Understand the basic format in constructing social-skill lessons, learn effective instructional strategies and the necessary system features to put social-skill instruction in place

in schools. This session was also presented at the 2014 National PBIS Leadership Forum.

**Presenters:** Dr. Tim Lewis, Director, MU PBS Center, Co-Director, PBIS National Center; Dr. Trisha Guffey, Assistant Principal, Maple Park Middle School, North Kansas City 74 School District; Diane Feeley, Tier 2-3 Consultant, MO SW-PBS

#### **4I: Going Deeper with Functional Behavior**

**Assessment (FBA)** *(Rooms 62-64)*

##### **Tier 3 – Application**

This session is designed for Tier 3 teams that have received FBA/BIP training. Engage in conversations that will allow you to deepen your understanding of the FBA process. Learn to implement FBA and more efficiently conduct FBAs that result in the development of a summary statement.

**Presenter:** Dr. Terry Bigby, Behavior Teacher Leader, Kansas City, Kansas Public Schools

## **BREAKOUT SESSION 5**

**June 11 • 2:45 – 4:00 p.m.**

#### **5A: Equity and SW-PBS Part 2: Using Discipline Data to Design Effective and Efficient Strategies to Reduce Disproportionality** *(Salon C)*

##### **Tiers 1, 2, 3 – Application**

Building on the previous session, teams will have the opportunity to use their school discipline data to design strategies to reduce disproportionality in school discipline.

**Presenter:** Dr. Kent McIntosh, Associate Professor, College of Education, University of Oregon

#### **5B: Student Voice and Ownership** *(Parasol II)*

##### **Tier 1 – Application**

Learn how to use student voice as a powerful tool to facilitate students becoming involved, invested and participating in SW-PBS. Hear how student voice has helped develop successful schoolwide programs such as chief change, student-designed and created videos and electronic Friday as well as how to partner with business leaders in the community to create a respectful, responsible and safe environment. Discover how to use student voice as a way to encourage student ownership in SW-PBS and receive strategies that can be implemented for the coming school year with very little cost.

**Presenters:** Laura Weisacosky, Teacher and SW-PBS Committee Chair; Dr. Kelly Mantz, Principal; Wentzville Middle School, Wentzville R-IV School District; Karen Westhoff, Regional SW-PBS Consultant, St. Louis RPDC, Education Plus

### **5C: Effective Use of Specific Positive Feedback in the Classroom** (*Salon A*)

#### **Tiers 1, 2, 3 – Application**

Use of specific positive feedback in the classroom is important to help students learn appropriate social behavioral skills. Effective specific positive feedback consists of stating the expectation, specifically describing the behavior and can include a positive consequence. Research recommends a ratio of 4:1; four comments in response to desired student behavior to one response to student misbehavior. Learn how to establish and sustain staff use of specific positive feedback at a ratio of 4:1 in the classroom setting.

**Presenter:** Danielle Starkey, Tier 2-3 Consultant, MO SW-PBS

### **5D: Small School...Big Results** (*Suite G*)

#### **Tier 1 – Application**

This session will focus on adjusting SW-PBS to address small school issues, how to get student and staff buy-in, and the different roles of the administrators, teachers and students. It's all about finding what works for your school no matter how big or how small.

**Presenters:** Aimee Brendehoeft, ReVay Schlitt, Leslie Basye and Tessa Moulton, Teachers; Brandon Figg, Principal; Concordia High School, Concordia R-II School District; Deanna Maynard, Tier 2-3 Consultant, MO SW-PBS; Linda Crain, Regional SW-PBS Consultant, Central RPDC

### **5E: Sustainability Through the SW-PBS Years**

(*Crystal Ballroom*)

#### **Tiers 1, 2, 3 – Application**

This session will focus on Tier 1 Sustainability and how one building has been able to implement positive behavior support with fidelity while facing faculty changes, administrative changes and growth in our student population. Learn tried and true methods that work as well as how to keep things fresh and new each year. Hear about methods that have continued to show success and those that were abandoned.

**Presenters:** Christina Mackey, Computer Educator; Stefanie Riggs, Teacher; Boswell Elementary School, Lebanon R-III School District; Jo Ann Anderson, Tier 2-3 Consultant, MO SW-PBS

### **5F: Using the SW-PBS Tiered Fidelity Inventory (TFI) to Guide Action Planning** (*Redbud*)

#### **Tiers 1, 2, 3 – Application**

Learn about Tiered Fidelity Inventory (TFI), which can be used to assess SW-PBS implementation for Tiers 1, 2 and 3. Review the features of the new measure and how it can be used to improve implementation. Examples from a school district will be provided.

**Presenter:** Dr. Kelsey Morris, Senior Research Assistant, PBISApps, University of Oregon

### **5G: SW-PBS and the Single Building** (*Rooms 74-76*)

#### **Tiers 1, 2, 3 – Application**

Being one of only a few buildings in your district implementing SW-PBS can be a challenge. Learn ways to overcome this barrier and sustain SW-PBS for the long haul. This session will focus on factors important to sustainability and how they can be achieved in isolated buildings, with emphasis on enhancing the essential components of MO SW-PBS.

**Presenter:** Kelly Nash, Regional SW-PBS Consultant, Kansas City RPDC

### **5H: Using a Big 5 Report to Develop a Targeted**

**Schoolwide Intervention** (*Rooms 60-61*)

#### **Tiers 1, 2, 3 – Application**

In this interactive presentation, learn a data-based decision-making model that leads to a precise definition of the problem. Create a solution plan that intensifies prevention, teaching, reinforcement and correction. Finally, learn strategies to monitor fidelity of implementing the plan, progress monitoring of outcomes and plan evaluation. *\*Please bring a device that can access your school's discipline data base (SWIS, Tyler/SIS, Big 5 Generator, etc.). Sample data can be downloaded for participants who do not have access to their discipline data base.*

**Presenter:** Dr. Gordon Way, Data/Web Consultant, MO SW-PBS

### **5I: Going Deeper with Behavior Intervention**

**Planning (BIP)** (*Rooms 62-64*)

#### **Tier 3 – Application**

This session is designed for Tier 3 teams that have received FBA/BIP training. Ask questions and engage in conversations that will allow you to deepen your understanding of the BIP process. Learn to more efficiently develop BIPs that increase pro-social behavior and decrease problem behavior.

**Presenter:** Dr. Terry Bigby, Behavior Teacher Leader, Kansas City, Kansas, Public Schools

## ROUND TABLE GUIDED NETWORKING

June 11 • 4:15 – 5:30 p.m.

These sessions will provide an opportunity for continuing conversations on specific SW-PBS topics. Networking presenters will “host” the discussions by providing a brief introduction to the topic and guiding questions for the group. Although each session will have initial focus questions to get the conversation started, any question on the topic is acceptable and participants are encouraged to come with questions of their own.

\*These sessions have a maximum number of 130 participants; participants will only be allowed entrance with a session ticket. Please see the registration desk if you need to be issued a ticket, would like to exchange your ticket for a different session or would like to return your ticket as you will no longer be attending.

**Networking 1: Using Self Management to Support Teachers with Classroom Management** (*Salon A*)  
**Session Leader:** Dr. Jennifer Freeman, Department of Educational Psychology, University of Connecticut

**Networking 2: Enhancing Sustainability of SW-PBS at the School and District Level** (*Salon C*)  
**Session Leader:** Dr. Kent McIntosh, College of Education, University of Oregon

**Networking 3: Sustaining SW-PBS at Tiers 2 and 3** (*Northwinds*)  
**Session Leader:** Dr. Tim Lewis, PBIS National Center and University of Missouri

**Networking 4: Sustaining SW-PBS Using PBIS Assessments** (*Redbud*)  
**Session Leader:** Dr. Kelsey Morris, PBISApps, University of Oregon

**Networking 5: Implementing to Sustain SW-PBS in Early Childhood Settings** (*Rooms 62-64*)  
**Session Leader:** Susanna Hill, MO SW-PBS

**Networking 6: Implementing to Sustain SW-PBS in Alternative Settings** (*Rooms 60-61*)  
**Session Leader:** Deb Lyons, MO SW-PBS

**Networking 7: Implementing to Sustain SW-PBS in High Schools** (*Parasol I*)  
**Session Leader:** Deb Childs, MO SW-PBS

## BREAKOUT SESSION 6

June 12 • 8:00 – 9:15 a.m.

**6A: Classroom Essential 8’s for the Early Childhood Setting** (*Redbud*)

**Tier 1 – Application**

Hear how one school found developmentally appropriate ways to use PBS at the early childhood level. Learn about the essentials 8’s, how to develop expectations and procedures for the preschool classroom, supervision and how to teach/encourage expected behaviors.

**Presenters:** Jen Meyer, Director of Early Childhood, Early Childhood Learning Center, Kirksville R-III School District; Susanna Hill, Tier 2-3 Consultant, MO SW-PBS

**6B: Meeting Students’ Needs Through a Community-Supported School Store** (*Suite G*)

**Tiers 1, 2, 3 – Enrichment**

Hear about the success of the Rebecca Boone Trading Post through stories, discipline data and the reasoning for starting the program. Learn about experiences with the community to help support the school store, strategies used to help students make wise decisions based on their attendance and discipline data that will work in multiple settings.

**Presenters:** Dr. Cheri Oliver, Assistant Principal; Dr. Jill Schowe, Principal; Rebecca Boone Elementary School, Warren Co. R-III School District; Christie Lewis, Regional SW-PBS Consultant, Heart of Missouri RPDC

**6C: Quiet on the Set: SW-PBS Filmmaking** (*Northwinds*)

**Tiers 1, 2, 3 – Application**

Video creation, though it can be daunting, can help communicate student expectations as well as help foster school community. Receive practical ideas for creating videos for your school’s SW-PBS program.

**Presenters:** Christopher Wright, Instructional Technology Specialist, Wyman Elementary School, Rolla 31 School District; Jo Ann Anderson, Tier 2-3 Consultant, MO SW-PBS

**6D: EPA: Environmental Protection Adaptations – How Do We Guarantee Success for All Students?** (*Salon C*)

**Tiers 1, 2, 3 – Application**

Learn to implement adaptations to create a student-centered environment. Receive strategies that will incorporate sensory, organizational and self-regulation skills to help all students be successful learners and develop the skills to be productive adults.

**Presenters:** Karen Westhoff, Regional SW-PBS Consultant, St. Louis RPDC, Education Plus; Deb Lyons, Regional SW-PBS Consultant, Northwest RPDC

**6E: Student Voice = Improved Outcomes, Involving Elementary Students in SW-PBS** (*Salon A*)

**Tier 1 – Application**

Learn how to create an environment where your students are more involved in your SW-PBS program. Research tells us that when students are involved in the decision-making progress, they will have a stronger sense of ownership, and the outcomes will be more effective and positive. Discover how to maintain the roles between the tiers and that connection; how to involve your students in the data-interpretation piece and develop goals for the school, specific grade levels and individual students, and how to incorporate feedback between students, students and staff and staff members. Receive ideas of how you can immediately incorporate this into your setting as well as sparking ideas to enhance a program that is already established.

**Presenters:** Susan Tinich, Principal; Terri Leonard, Teacher; Midway Elementary School, Midway R-I School District; Deanna Maynard, Tier 2-3 Consultant, MO SW-PBS; Linda Crain, Regional SW-PBS Consultant, Central RPDC

**6F: Moving in One Direction with Several Moving Parts: District-Wide SW-PBS Implementation in Raytown Schools** (*Rooms 60-61*)

**Tiers 1, 2, 3 – Application**

Hear about the SW-PBS journey in Raytown School District. Since starting SW-PBS as a district initiative in 2011, school teams with different populations have been working through the RPDC and state training to develop and implement systems within the framework of SW-PBS, seeing an overall decrease in out-of-school suspensions and an overall increase in attendance and school engagement. Schools are moving at their own pace with district-level support and collaboration, and the district is moving forward in the SW-PBS journey.

**Presenters:** Dr. Staci M. Mathes, Director of Student Support Services; Raytown Quality Schools, Raytown C-2 School District; Dr. Gordon Way, Data/Web Consultant, MO SW-PBS

**6G: Staying in the LOOP...Continuing the Support of the Tiers** (*Crystal Ballroom*)

**Tiers 1, 2 – Application**

How does a school continue to keep staff informed about SW-PBS to ensure sustainability? Chaffee Elementary will share how it keeps its veteran and new teachers up to date with current systems, data and practices including professional development and staff handbook.

**Presenters:** Michele Williams, Principal; Shawn Nix, Assistant Principal/Special Education Director, Carrie Cain and Tammy Simminger, Teachers; Chaffee Elementary School, Chaffee R-II School District; Debbie Lintner, Tier 2-3 Consultant, MO SW-PBS

**6H: Developing High Quality Behavior Intervention Plans** (*Rooms 62-64*)

**Tier 3 – Application**

Learn to assess the quality of FBAs and BIPs at Tier 3, and how to complete and use a rubric that assesses necessary components and ensures that time spent on FBAs and BIPs results in a high quality plan that will yield positive results.

**Presenter:** Betty Ennis, Tier 2-3 Consultant, MO SW-PBS

**6I: Tier 3: Preventing and Responding to Learning and Behavior Problems: A Collaborative Approach between General and Special Education Communities** (*Parasol II*)

**Tier 3 – Application**

Discover how to support inclusive programming for all students and organize for Tier 3 Intensive Interventions (FABI, RENEW, Wraparound). Learn how to design, implement and evaluate rigorous functional assessment-based interventions using a systematic approach to assist students for whom primary prevention efforts are insufficient.

**Presenter:** Dr. Lisa Powers, Area Coordinator, Special School District of St. Louis County

**BREAKOUT SESSION 7**

**June 12 • 9:30 – 10:45 a.m.**

**7A: Ensuring the Presence and Fidelity of Effective Classroom Practices to Increase Positive Student Behavior** (*Salon A*)

**Tier 1 – Application**

Hear an overview of the year-long process that Brookfield Middle School used to determine whether effective classroom practices were used in all classrooms, and if they were being implemented with fidelity, in order to provide relevant professional development that would increase student success. Receive information about the framework needed to look for these practices, determine fidelity and plan professional development in your own buildings.

**Presenters:** Katie Andreasen, Middle School Instructional Coach; Angie Sensenish and Marty Stark, Teachers; Brookfield Middle School, Brookfield R-III School District; Jill Miller, Regional SW-PBS Consultant, Northeast RPDC

**7B: Building a Community Partnership Program**  
(*Northwinds*)

**Tiers 1, 2, 3 – Enrichment**

Fire up your SW-PBS program by bringing hands-on, meaningful experiences into the classroom led by business leaders and workers in your own community. Begin a business partnership program in your community and facilitate relationships between business leaders, teachers and the students at your school that will ignite their career aspirations and generalize expected behaviors to other settings in your community.

**Presenter:** Karin Leveke, Tier 2-3 Consultant, MO SW-PBS

**7C: “Everything is Awesome” – Celebrating and Sustaining Tier 1 in a Tier 3 School** (*Salon C*)

**Tiers 1, 2, 3 – Application**

After seven years as a SW-PBS school, hear how one school is committed to sustaining their Tier 1 practices and procedures as the foundation. See the transformations taken to become a Tier 3/Gold building – from individual to classroom recognition as well as building-wide celebrations. Receive ideas to boost building morale as well as teacher and student participation in the SW-PBS program.

**Presenters:** Samantha Trankler, Principal; Krista Birk, Assistant Principal; Lauren Skelton and Shannon Juenger, Teachers; West Lane Elementary School, Jackson R-II School District; Cynthia Matthew, Regional SW-PBS Consultant, Southeast RPDC

**7D: Using the SW-PBS Tiered Fidelity Inventory (TFI) to Guide Action Planning** (*Redbud*)

**Tiers 1, 2, 3 – Application**

Repeat of Session 5F.

**7E: Utilizing Effective Leadership to Sustain SW-PBS Practices** (*Suite G*)

**Tiers 1, 2, 3 – Application**

Learn the role of the administrator in establishing and sustaining effective schoolwide PBS systems through the lens of South Park Elementary. Hear about the journey of initial implementation through the Tier 3 maintenance phase. Discover how to maintain a high level of fidelity with a mobile staff and student population while including parent and community support.

**Presenters:** Dr. Tim Roth, Principal, South Park Elementary School, Moberly School District; Christie Lewis, Regional SW-PBS Consultant, Heart of Missouri RPDC

**7F: Using MO SW-PBS Podcasts and Video to Develop Staff Expertise with Effective Classroom Practices** (*Crystal Ballroom*)

**Tiers 1, 2, 3 – Application**

Learn about Content Acquisition Podcasts (CAPs) and accompanying videos featuring Missouri elementary and middle schools. Classroom rules and expectations, classroom procedures and routines, and encouraging expected behavior and discouraging inappropriate behavior in the classroom will also be discussed. Hear how the CAPs and videos can be used as professional development for new and returning staff.

**Presenters:** Diane Feeley, Tier 2-3 Consultant, MO SW-PBS; Linda Bradley, Research Assistant, MU Center for PBS, University of Missouri

**7G: Progress Monitoring at Tier 2** (*Rooms 62-64*)

**Tier 2 – Application**

Learn ways to progress monitor any student in a Tier 2 intervention. The purpose of progress monitoring is to use data to make informed decisions. It increases student success and allows systematic discussions and decision making based on facts.

**Presenter:** Deb Childs, Tier 2-3 Consultant, MO SW-PBS

**7H: Creating the Right Conditions for Success: Notes from a High School** (*Parasol II*)

**Tier 1 – Application**

Creating conditions where students are in classrooms, potentially learning, for the maximum amount of time is key at Lebanon High School. Thinking of the big picture with an emphasis on social-emotional learning, including evidenced-based interventions at all three tiers, they are preventing the bulk of behavior problems. Learn about embedded systems and practices to decrease behaviors and increase student engagement and parent participation through the Yellow Jacket Code (SW-PBS) and academic success.

**Presenters:** Kevin Lowery, Principal; Justin Slye, Teacher and PBS Coach; Bob Matthews, Assistant Principal; Lebanon High School, Lebanon R-III School District; Jo Ann Anderson, Tier 2-3 Consultant, MO SW-PBS

# School Recognition Awards

## **GOLD**

### **Bayless**

Bayless Elementary

### **Carl Junction R-I**

Carl Junction Primary K-1

### **Dexter R-XI**

Southwest Elementary

### **Dixon R-I**

Dixon Elementary

### **Excelsior Springs 40**

Elkhorn Elementary  
Excelsior Springs Middle

### **Francis Howell R-III**

Saeger Middle

### **Fulton 58**

Bartley Elementary

### **Hazelwood**

Hazelwood Early Childhood  
Education Centers  
Jana Elementary

### **Hillsboro R-III**

Hillsboro Primary

### **Joplin R-VIII**

Beacon School

### **Kirkville R-III**

Early Childhood Learning Center  
Kirkville Primary

### **Kirkwood R-VII**

Westchester Elementary

### **Lebanon R-III**

Boswell Elementary  
Hillcrest School  
Joe D. Esther Elementary  
Lebanon High  
Maplecrest Elementary

### **Marceline R-V**

Walt Disney Elementary

### **Marshfield R-I**

Daniel Webster Elementary

### **Mehlville R-IX**

John Cary Early Childhood Center  
Oakville Middle

### **Midway R-I**

Midway Elementary

### **Moberly**

Gratz Brown Elementary  
South Park Elementary

### **Nixa R-II**

Mathews Elementary

### **Ozark R-VI**

East Elementary  
North Elementary

### **Pattonville R-III**

Pattonville Early Childhood Center

### **Reeds Spring R-IV**

Reeds Spring High  
Reeds Spring Middle

### **Ritenour**

Iveland Elementary  
Marvin Elementary  
Ritenour Middle

### **Rolla 31**

Wyman Elementary

### **Sikeston R-6**

Sikeston 5th & 6th Grade Center

### **Southern Boone Co. R-I**

Southern Boone Elementary

### **Southwest R-V**

Southwest Middle

### **Special School District of St. Louis County**

Hiram Neuwoehner High

### **Strafford R-VI**

Strafford Elementary  
Strafford Middle

### **University City**

Pershing Elementary

### **Walnut Grove R-V**

Walnut Grove Elementary

### **Warren Co. R-III**

Rebecca Boone Elementary  
Warrior Ridge Elementary

### **Waynesville R-VI**

East Elementary  
Freedom Elementary  
Partridge Elementary  
Wood Elementary

### **Webster Groves**

Hudson Elementary

### **Winfield R-IV**

Winfield Intermediate  
Winfield Primary

## **SILVER**

### **Cape Girardeau 63**

Clippard Elementary

### **Chaffee R-II**

Chaffee Elementary

### **Concordia R-II**

Concordia High

### **Crawford Co. R-II**

Cuba Middle

### **Crystal City 47**

Crystal City Elementary

### **Desoto**

Athena Elementary

### **El Dorado Springs R-II**

El Dorado Springs Elementary

### **Excelsior Springs R-40**

Excelsior Springs High

### **Ferguson Florissant R-II**

Combs Elementary  
Griffith Elementary  
Halls Ferry Elementary  
Holman Elementary  
McCluer High  
Wedgwood Elementary



# School Recognition Awards

**Francis Howell R-III**

Central Elementary  
Daniel Boone Elementary  
Henderson Elementary

**Fredericktown R-I**

Fredericktown Elementary  
Fredericktown Intermediate

**Fulton 58**

Bush Elementary

**Golden City R-III**

Golden City K-12

**Hamilton R-II**

Hamilton Elementary

**Hancock Place**

Hancock Place Elementary  
Hancock Place Middle

**Hazelwood**

Barrington Elementary  
Brown Elementary  
Hazelwood East Middle  
Keeven Elementary  
Lawson Elementary

**Jackson R-2**

South Elementary

**Jasper Co. R-V**

Jasper Co. Elementary  
Jasper High

**Joplin R-VIII**

McKinley Elementary

**Kansas City 33**

Wendell Phillips Elementary

**La Monte R-IV**

La Monte Elementary

**Marshfield R-I**

Shook Elementary

**Mehlville R-IX**

Bernard Middle  
Blades Elementary  
Forder Elementary

**Meramec Valley R-III**

Meramec Valley Middle

**Mexico 59**

Hawthorne Elementary

**Milan C-2**

Milan Elementary

**Moberly**

North Central Regional Schools  
North Park Elementary

**Neosho R-V**

George Washington Carver  
Elementary

**North Callaway R-I**

Williamsburg Elementary

**North Kansas City 74**

Clardy Elementary  
Gashland Elementary  
West Englewood Elementary

**North St. Francois Co. R-I**

North County Intermediate  
North County Primary  
Parkside Elementary

**Ozark R-VI**

South Elementary  
Upper Elementary

**Pattonville R-III**

Parkwood Elementary

**Pierce City R-VI**

Central Elementary

**Poplar Bluff R-I**

Lake Road Elementary

**Reeds Spring R-IV**

Reeds Spring Intermediate

**Ritenour**

Buder Elementary  
Wyland Elementary

**Salem R-80**

William Lynch Elementary

**School of the Osage R-II**

Upper Elementary

**Sedalia 200**

Sedalia Middle

**Sikeston R-6**

Sikeston Junior High

**Southern Boone Co. R-I**

Southern Boone Primary

**Special School District  
of St. Louis County**

Northview High

**St. Clair R-XIII**

Edgar Murray Elementary

**St. Joseph**

Oak Grove Elementary  
Pickett Elementary

**Strafford R-VI**

Strafford High

**University City**

Barbara C. Jordan Elementary  
Brittany Woods Middle  
Julia Goldstein Early Childhood  
Education Center

**Warren Co. R-III**

Daniel Boone Elementary

**Waynesville R-VI**

Thayer Elementary  
Waynesville 6th Grade Center

**Wentzville R-IV**

Discovery Ridge Elementary  
Green Tree Elementary

**West St. Francois Co. R-IV**

West County Elementary

**Westran R-I**

Westran Elementary  
Westran High  
Westran Middle

**Winfield R-IV**

Winfield High

# School Recognition Awards

## **BRONZE**

### **Bayless**

Bayless Jr. High

### **Belton 124**

Cambridge Elementary

### **Bolivar R-I**

Bolivar Intermediate  
Bolivar Primary

### **Branson R-IV**

Cedar Ridge Elementary  
Cedar Ridge Intermediate

### **Braymer C-4**

Braymer Elementary  
Braymer High

### **Brookfield R-III**

Brookfield Elementary  
Brookfield Middle

### **Cape Girardeau 63**

Cape Central Academy  
Jefferson Elementary

### **Carl Junction R-I**

Carl Junction Primary 2-3

### **Carrollton R-VII**

Carrollton Middle

### **Caruthersville 18**

Caruthersville Middle

### **Centralia**

Chance Elementary

### **Chilhowee R-IV**

Chilhowee Elementary  
Chilhowee High

### **Clinton**

Henry Elementary

### **Confluence Charter**

Confluence Academy-Old North  
Confluence Academy-South City  
Confluence Academy-Walnut  
Park

### **Crawford Co. R-I**

Bourbon Elementary

### **Desoto**

Vineland Elementary

### **Dixon R-I**

Dixon Middle

### **East Carter Co. R-II**

East Carter Middle

### **Ferguson Florissant R-II**

Berkeley Middle  
Central Elementary  
Commons Lane Elementary  
Vogt Elementary

### **Fox C-6**

Don Earl Early Childhood  
Center

### **Francis Howell R-III**

Independence Elementary

### **Galena R-II**

Galena-Abesville Elementary

### **Gasconade Co. R-II**

Gerald Elementary  
Owensville Elementary

### **Grandview C-4**

Grandview Middle

### **Hazelwood**

Garrett Elementary  
Townsend Elementary  
Walker Elementary

### **Independence 30**

Procter Elementary

### **Iron Co. C-4**

Viburnum Elementary

### **Jackson R-2**

Gordonville Elementary  
Millersville Elementary  
North Elementary

### **Jefferson City**

Cedar Hill Elementary  
Thorpe Gordon Elementary

### **Joplin R-VIII**

Irving Elementary  
Jefferson Elementary  
Kelsey Norman Elementary

### **Kansas City 33**

Garfield Elementary

### **Lebanon R-III**

Lebanon Junior High

### **Lewis Co. C-I**

Highland Elementary

### **Madison C-3**

Madison Elementary

### **Maries County R-II**

Belle Elementary

### **Marshfield R-I**

Edwin P. Hubble Elementary

### **Maryville R-II**

Eugene Field Elementary

### **Mehlville R-IX**

Beasley Elementary  
Bierbaum Accelerated School  
Margaret Buerkle Middle  
Mehlville Senior High  
Oakville Elementary  
Rogers Elementary  
Scope/SSLCMS  
Trautwein Elementary  
Washington Middle  
Wohlwend Elementary

### **Meramec Valley R-III**

Robertsville Elementary

### **Mexico 59**

McMillan Elementary

### **Moberly**

Moberly Early Childhood

### **Neosho R-V**

Benton Elementary  
Central Elementary  
Field Early Childhood Center  
Goodman Elementary  
Neosho High  
South Elementary

# School Recognition Awards

## **Nevada R-V**

Benton Elementary  
Truman Elementary

## **Nixa R-II**

Century Elementary

## **North Kansas City 74**

Fox Hill Elementary  
Linden West Elementary

## **Northwest R-I**

Northwest Early Childhood  
Center

## **Norwood R-1**

Norwood Elementary

## **Ozark R-VI**

West Elementary

## **Phelps Co. R-III**

Phelps County Elementary

## **Pleasant Hope R-VI**

Pleasant Hope Elementary

## **Raytown C-2**

Blue Ridge Elementary  
Eastwood Hills Elementary  
Fleetridge Elementary  
Laurel Hills Elementary  
Little Blue Elementary  
New Trails Early Learning Center  
Norfleet Elementary  
Northwood School  
Raytown Central Middle  
Raytown High  
Raytown Middle  
Raytown South High  
Raytown South Middle  
Robinson Elementary  
Southwood Elementary  
Spring Valley Elementary  
Westridge Elementary

## **Reeds Spring R-IV**

Reeds Spring Elementary  
Reeds Spring Primary

## **Ritenour**

Ritenour ECC

## **Riverview Gardens**

Central Middle

## **Salem R-80**

Salem Upper Elementary

## **Sedalia 200**

Heber Hunt Elementary  
Horace Mann Elementary  
Parkview Elementary  
Skyline Elementary  
Washington Elementary

## **Sikeston R-6**

Matthews Elementary  
Sikeston Kindergarten Center

## **Southern Boone Co. R-I**

Southern Boone High

## **St. Louis Language Immersion**

The Chinese School

## **St. Elizabeth R-IV**

St. Elizabeth R-IV

## **St. James R-I**

Lucy Wortham James Elementary

## **St. Louis City**

Bryan Hill Elementary  
Froebel Elementary  
Hamilton Elementary  
Oak Hill Elementary  
Woerner Elementary

## **Stoutland R-II**

Stoutland Elementary

## **Tri-County R-VII**

Tri-County Elementary

## **Troy R-III**

Troy 9th Grade Center

## **United Services for Children**

United Services for Children

## **University City**

Flynn Park Elementary  
Jackson Park Elementary

## **Washington**

Augusta Elementary  
Labadie Elementary

## **Waynesville R-VI**

Williams Early Childhood Center

## **Wentzville R-IV**

Boone Trail Elementary  
Crossroads Elementary  
Duello Elementary  
Frontier Middle  
Heritage Intermediate  
Heritage Primary  
Peine Ridge Elementary  
Prairie View Elementary  
Wentzville Alternative Program  
Wentzville Middle  
Wentzville South Middle

## **Winston R-VI**

Winston Elementary

# Leadership Team Action Planning Worksheet

School Name \_\_\_\_\_

Team Members \_\_\_\_\_

\_\_\_\_\_

\_\_\_\_\_

Assign team members by session time, name and location.

	Wednesday, June 10				Thursday, June 11							
Team Member	Welcome and Opening Remarks 1:00–1:45	Regional Time and Recognition 2:00–3:15	Session 1 3:30–4:45	Poster, Web and Video Session 5:00–6:00	Breakfast Buffet 7:00–7:45	Keynote Address 8:00–8:45	Session 2 9:00–10:15	Session 3 10:30–11:45				

	Thursday, June 11 (continued)				Friday, June 12					
Team Member	Lunch and Team Time 11:45–1:00	Session 4 1:15–2:30	Session 5 2:45–4:00	Networking 4:15–5:30	Breakfast Buffet 7:00–7:45	Session 6 8:00–9:15	Session 7 9:30–10:45	Team Time 11:00–12:15		

# MO SW-PBS Team

## STATE PERSONNEL

### **Tim Lewis\***

MU SW-PBS Center Director  
lewistj@missouri.edu

### **Nanci Johnson\***

State Director  
johnsonnw@missouri.edu

### **Gordon Way\***

Web/Data Consultant  
wayg@missouri.edu

## TIER 2/TIER 3 CONSULTANTS

**Jo Ann Anderson** (Region 6)  
joann@missouri.edu

**Jimmie Bullard** (Regions 3 & 5)  
bullardjd@umkc.edu

**Deb Childs** (Region 8)  
childsde@missouri.edu

**Betty Ennis** (Region 7)  
ennisb@missouri.edu

**Diane Feeley** (Regions 3 & 5)  
feeleyd@missouri.edu

**Susanna Hill** (Region 7 & EC)  
hillsj@missouri.edu

**Karin Leveke** (Region 2)  
levekek@missouri.edu

**Debora Lintner** (Region 1)  
lintnerdr@missouri.edu

**Deanna Maynard** (Regions 4 & 9)  
maynarddk@missouri.edu

**Danielle Starkey**  
starkeyd@missouri.edu

## REGIONAL CONSULTANTS

### **Maria Allen**

Southeast RPDC (Region 1)  
mallen@semo.edu

### **Cynthia Matthew**

Southeast RPDC (Region 1)  
cjmatthew@semo.edu

### **Amanda Holloway**

Heart of Missouri RPDC (Region 2)  
hollowayal@missouri.edu

### **Christie Lewis**

Heart of Missouri RPDC (Region 2)  
lewischri@missouri.edu

### **Lauren Robb**

Heart of Missouri RPDC (Region 2)  
robblm@missouri.edu

### **Erin Klein**

Kansas City RPDC (Region 3)  
kleinel@umkc.edu

### **Teresa Tulipana**

Kansas City RPDC (Region 3)  
tulipanat@umkc.edu

### **Kelly Nash**

Kansas City RPDC (Region 3)  
vinesk@umkc.edu

### **Jill Miller**

Northeast RPDC (Region 4)  
jillmiller@truman.edu

### **Deb Lyons**

Northwest RPDC (Region 5)  
dlyons@nwmissouri.edu

### **Karen Wigger**

Northwest RPDC (Region 5)  
kwigger@nwmissouri.edu

### **Becky Boggs**

South Central RPDC (Region 6)  
boggsre@mst.edu

### **Jeanie Carey**

South Central RPDC (Region 6)  
careyje@mst.edu

### **Lori Slater**

Southwest RPDC (Region 7)  
lorislater@missouristate.edu

### **Andrea Rockney**

Southwest RPDC (Region 7)  
arockney@missouristate.edu

### **Marsha Hightower**

EducationPlus (Region 8)  
mhightower@edplus.org

### **Karen Westhoff**

EducationPlus (Region 8)  
kwesthoff@edplus.org

### **Linda Crain**

Central RPDC (Region 9)  
lcrain@ucmo.edu

## DESE PERSONNEL

### **Tiffani Muessig\***

Effective Practices Assistant Director  
tiffani.muessig@dese.mo.gov

### **Pam Williams\***

Special Education Coordinator  
pam.williams@dese.mo.gov

### **Ginger Henry\***

Effective Practices Director  
ginger.henry@dese.mo.gov

## MU SW-PBS CENTER PERSONNEL

### **Linda Bradley**

Research Assistant  
bradleyl@missouri.edu

### **Sarah Moore**

Research Assistant  
mooresarah@missouri.edu

**\*State Leadership Team**



# Facility Layout



**BUILDING A & B**  
(Meeting and Facilities Directional Map)

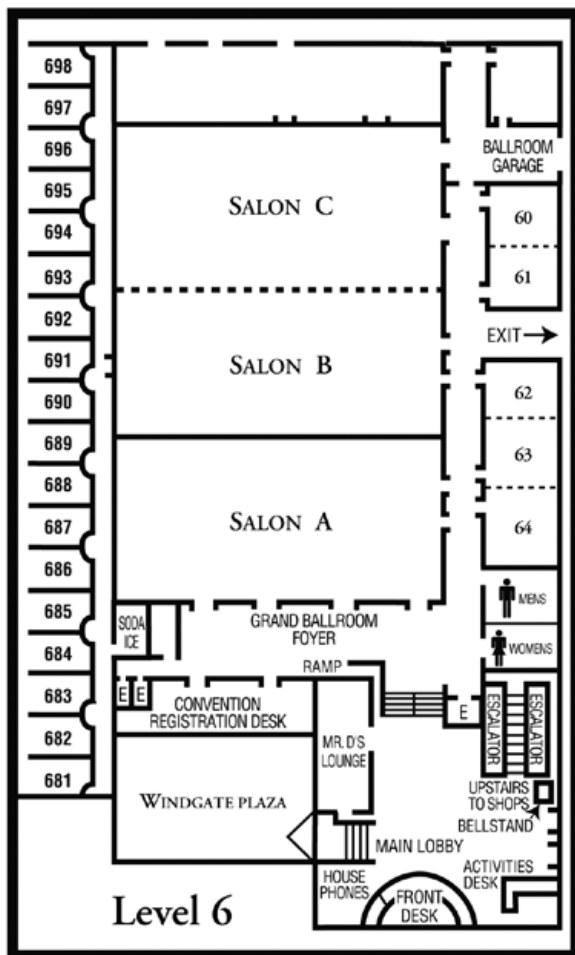

**CRYSTAL BALLROOM:** Go down Market Lane, past all shops, down three flights of stairs, to our Social Lobby. At the Social Lobby take the short flight of carpeted steps up to the Crystal Ballroom, which is on your left.

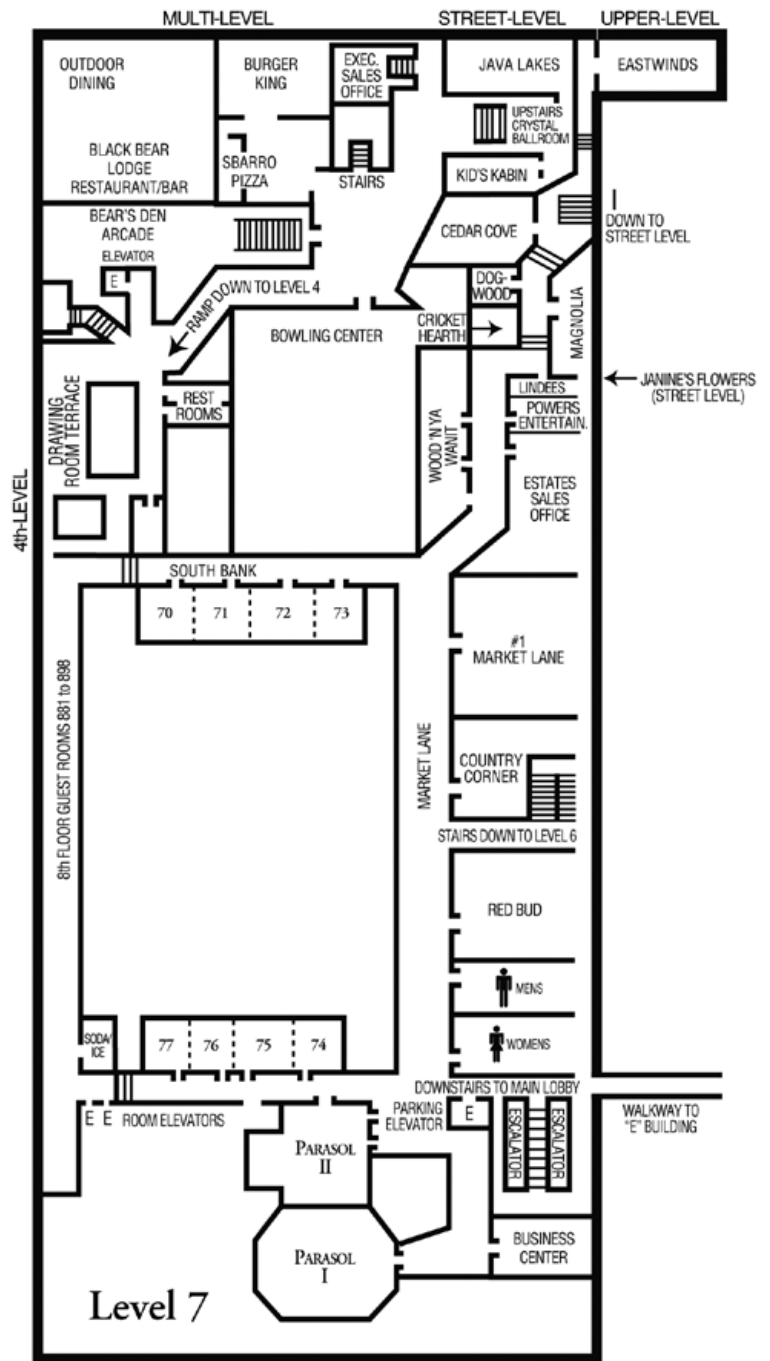

**NORTHWINDS AND SUITE G:** Take escalator or elevator from the Main Lobby up to the catwalk to Building E. Cross the catwalk to the 3rd level of Building E. Go left at Building E's main corridor and proceed out the side door into the stairwell where you will exit through the door on your left. Go across the road and into Building D, entering through the double glass doors on your left. Northwinds and Suite G are in Building D, next door to each other.

# Missouri Counties with Schools Implementing Schoolwide Positive Behavior Support 2014-2015

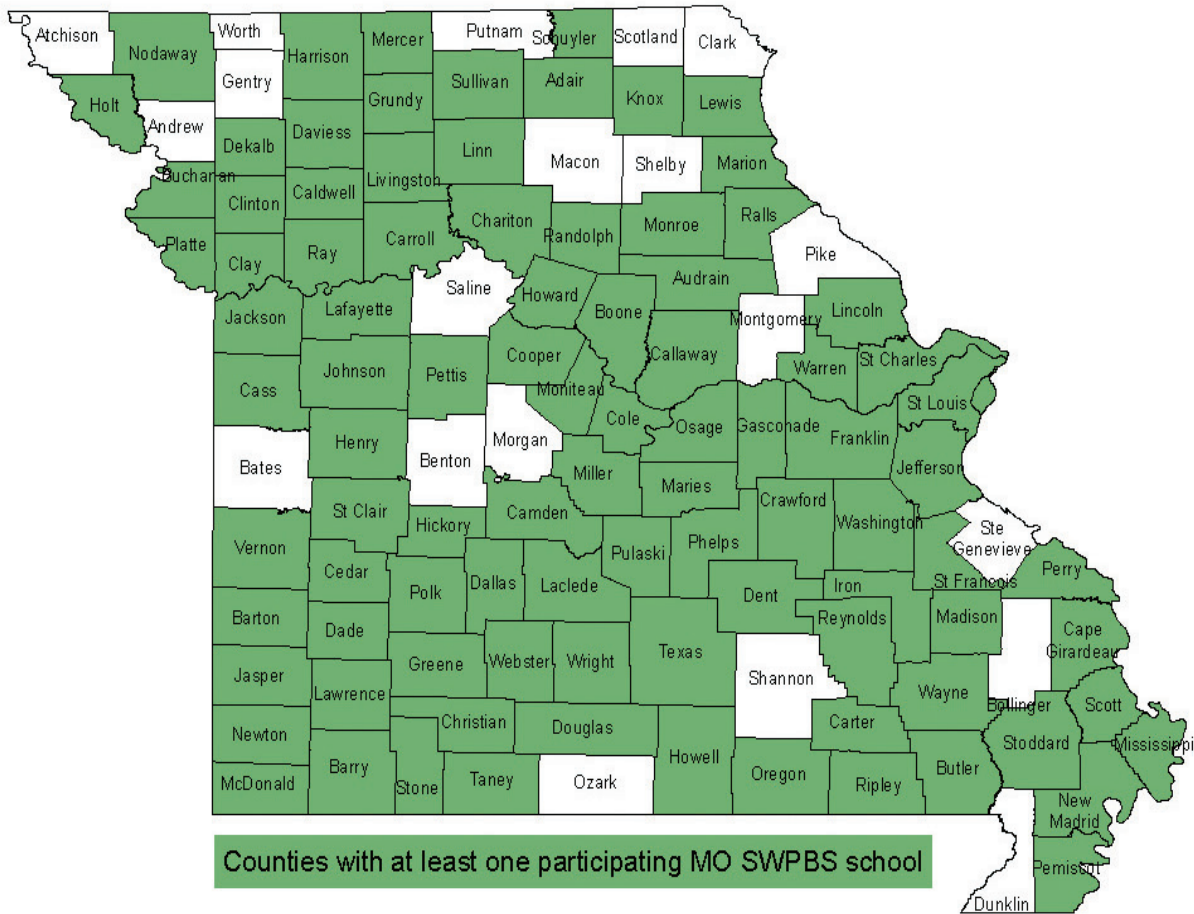

**sustaining**  
effective practices for student outcomes

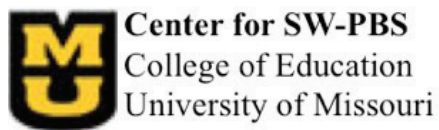
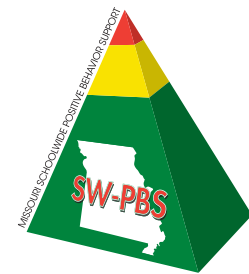

Visit us online at [pbissmissouri.org/](http://pbissmissouri.org/) or follow us on TWITTER at #MOSWPBS.

*The Department of Elementary and Secondary Education does not discriminate on the basis of race, color, religion, gender, national origin, age, or disability in its programs and activities. Inquiries related to Department programs and to the location of services, activities, and facilities that are accessible by persons with disabilities may be directed to the Jefferson State Office Building, Office of the General Counsel, Coordinator, Civil Rights Compliance (Title VI/Title IX/504/ADA/Age Act), 6th Floor, 205 Jefferson Street, P.O. Box 480, Jefferson City, MO 65102-0480; telephone number 573-526-4757 or TTY 800-735-2966; fax number 573-522-4883; email [civilrights@dese.mo.gov](mailto:civilrights@dese.mo.gov).*