

Missouri Schoolwide Positive Behavior Support
SUMMER TRAINING INSTITUTE 2013

**PAY IT
FORWARD**
WITH SW-PBS FOR SCHOOL SUCCESS



June 12-14, 2013
Tan-Tar-A Resort, Osage Beach, Missouri

WELCOME



205 Jefferson Street, P.O. Box 480 • Jefferson City, MO 65102-0480 • dese.mo.gov

June 2013

Dear Training Institute Participants:

Welcome to the 2013 Missouri Schoolwide Positive Behavior Support (SW-PBS) Summer Training Institute: Pay It Forward with SW-PBS for School Success.

On behalf of the Missouri State Board of Education and the Department of Elementary and Secondary Education, I want to express our appreciation for your exceptional work with Missouri's students.

The training institute sessions emphasize building sustainable school systems to support the academic and social behavioral achievement of all students throughout their school career.

I hope you find the sessions meaningful and informative and have a successful training institute experience in which you gain research-based instructional skills to promote maximum student learning.

I look forward to working with you to achieve our Top 10 by 20 goal.

Sincerely,

A handwritten signature in cursive script that reads "Margie Vandeven".

Margie Vandeven
Deputy Commissioner
Division of Learning Services

AGENDA

Tuesday, June 11

6:00 – 9:00 p.m. **Registration** (*Salon Foyer*)

Wednesday, June 12

8:30 – 11:00 a.m. **Registration** (*Salon Foyer*)

11:30 a.m. – 1:00 p.m. **Lunch** (*Salons A-C*)
Keynote Address and State Recognitions

1:15 – 2:15 p.m. **Regional Time and Recognitions with Regional Directors**
Central Region (*Rooms 74-75*) Heart of Missouri Region (*Redbud*)
Kansas City Region (*Parasol I*) Northeast Region (*Parasol II*)
Northwest Region (*Rooms 60-61*) South Central Region (*Northwinds*)
Southeast Region (*Rooms 62-64*) Southwest Region (*Crystal Ballroom*)
Special School District (*Rooms 72-73*) St. Louis Region (*Suite G*)

2:30 – 3:45 p.m. **Breakout Session 1**

4:00 – 5:15 p.m. **Breakout Session 2**

Thursday, June 13

7:00 – 8:00 a.m. **Breakfast Buffet** (*Windgate Hall*)

8:15 – 9:00 a.m. **Keynote Address** (*Salons A-C*)

9:15 – 10:30 a.m. **Breakout Session 3**

10:45 a.m. – 12:00 p.m. **Breakout Session 4**

12:00 – 1:30 p.m. **Lunch and Team Time** (*Windgate Hall*)

1:45 – 3:00 p.m. **Breakout Session 5**

3:15 – 4:30 p.m. **Breakout Session 6**

4:45 – 6:00 p.m. **Hors d'oeuvres** (*Salons B-C*)
Poster, Web and Video Session

Friday, June 14

7:00 – 8:00 a.m. **Breakfast Buffet** (*Windgate Hall*)

8:15 – 9:30 a.m. **Breakout Session 7**

9:45 – 11:00 a.m. **Breakout Session 8**

11:15 a.m. – 12:30 p.m. **Team Time**
Central Region (*Rooms 74-75*) Heart of Missouri Region (*Redbud*)
Kansas City Region (*Parasol I*) Northeast Region (*Parasol II*)
Northwest Region (*Rooms 60-61*) South Central Region (*Northwinds*)
Southeast Region (*Rooms 62-64*) Southwest Region (*Crystal Ballroom*)
Special School District (*Rooms 72-73*) St. Louis Region (*Suite G*)

Name Badge Required for Admittance to Meals/Sessions

PRESENTERS

Dr. Tim Lewis has taught students with emotional and behavioral disorders in high school, elementary and self-contained psychiatric settings, and has been involved with developing schoolwide systems of behavioral support for more than 15 years. He is a professor of special education at the University of Missouri. He directs the University of Missouri Center for School-wide Positive Behavior Support and is co-director of the OSEP Technical Assistance Center on Positive Behavioral Interventions and Supports and the Institute for Educational Science (IES) Center for Adolescent Research in Schools. His specialty areas include social skills instruction, functional assessment and proactive schoolwide discipline systems.

Susan Barrett is the director of the PBIS Regional Training and Technical Assistance Center at Sheppard Pratt Health System, where she has also served as a teacher, an administrator and a coordinator since starting there in 1993. Barrett also works with the OSEP Technical Assistance Center on Positive Behavioral Interventions and Supports as an implementer partner. She works with Johns Hopkins University to evaluate the impact of PBIS on students, school staff and school communities.

Dr. Becky Beckner is an associate professor of education at Iowa Wesleyan College where she facilitates the early childhood program, teaches classroom management courses, and directs student teaching and practicum experiences. She is a trainer of early childhood PBIS throughout the nation. Beckner was an early childhood behavior consultant with the Columbia Public Schools in Columbia, Mo., for 15 years, where she coordinated the district's early childhood PBIS team efforts.

Dr. Rachel Freeman is the project director of the Kansas Institute for Positive Behavior Support (KIPBS), an associate research professor at the Life Span Institute in the University of Kansas (KU) and an adjunct faculty member in the Department of Special Education at KU. Freeman works with state, regional and local positive behavior support teams interested in wide-scale dissemination of positive behavior support within an interagency framework, including facilitation of positive behavior support in districts and schools implementing positive behavioral interventions and supports, as well as in residential and vocational settings supporting adults with disabilities.

Keith Hoyer has taught high school students about business for nineteen years. He is a consultant/presenter for the Montana Behavior Initiative (MBI-PBIS), is a member of the Montana State MBI Council and chairs the MBI program in the K-12 Belt School District. Hoyer has worked with high school staff and students across Montana, with the Pearson Foundation/Quaglia Institute's "My Voice" Survey. He specializes in utilizing student voice to promote improvement in school climate and foster positive student/staff interactions.

Dr. Michael Kennedy is an assistant professor of special education in the Curry School of Education at the University of Virginia. While serving as a high school special education teacher, he was a PBIS team member and coach who specialized in creating homegrown videos to achieve teacher and student buy-in and help improve outcomes. Schools around the country use Kennedy's videos as templates and exemplars for their own videos. He also hosts an annual film festival at the annual International Association for Positive Behavioral Support Conference for schools who create and use video in support of their schools' PBIS systems and practices.

Laura Riffel, Ph.D., is a behaviorist who specializes in helping adults make proactive changes so that targeted behaviors of children disappear. She has trained teachers, parents, counselors, psychologists, administrators and bus drivers on how to make data-based decisions as a way to change behavior. Riffel served as the webmaster for the OSEP Technical Assistance Center on Positive Behavioral Interventions and Supports from 1999-2012.

Jill Schofield has led the implementation of positive behavior for learning (PBL) in the Western Sydney Region since its inception in 2005, beginning with 13 schools and scaling up to a current 161 schools. She also led the establishment of New South Wales (NSW) statewide structures to assist the state's 10 regions in implementing PBL with integrity and fidelity. Currently, 796 schools have trained to implement universal prevention in NSW public schools. In 2007, Schofield was awarded a Churchill Fellowship to study PBIS implementation in the United States at the federal, state, regional, district and school levels.

SESSIONS

BREAKOUT SESSION 1

June 12 • 2:30 – 3:45 p.m.

1A: Successful Urban Leaders (*Rooms 60-61*)

This urban school has gone from challenges to success in academics and behavior over a two-year period. Genesis Promise Academy is meeting the needs of the urban student by implementing SW-PBS and essential practices.

Tier 2 – Application

Presenters: Dr. Phillip Hickman, Principal; Kevin Foster, Director for Curriculum and Instruction; and Gretchen Penner, Teacher, Genesis Promise Academy, Kansas City, Mo.

1B: Recognition at Elementary (*Salon C*)

Learn how this elementary school helped staff understand the power and use of positive feedback to encourage expected behaviors at a high rate (4:1) in all settings. Strategies used to encourage appropriate behavior will be shared.

Tier 1 – Foundation

Presenters: Melissa Menze and Teresa Paszkiet, Teachers and SW-PBS Coaches; and Carmen Ott, Teacher, Eugene Field Elementary, Hannibal 60 School District

1C: Project LAUNCH: Implementing Early Childhood Positive Behavior Support to Ensure Successful Transition to Elementary (*Parasol II*)

Boone County Project LAUNCH (Linking Actions for Unmet Needs in Children's Health) is dedicated to strengthening the network of parents and providers and to establishing a nurturing community that enhances the health and wellness of children and families, allowing them to reach their full potential. A panel comprised of representatives from the Project LAUNCH-funded Early Childhood Positive Behavior Support Training/Coaching Project discusses the work that has been done with targeted child-care providers in Boone County.

Tier 1 – Foundation

Presenters: Dr. Becky Beckner, Associate Professor, Early Childhood Education, Iowa Wesleyan College; Susan Brawley, Consultant; Vickie Davolt, Mental Health Coordinator and Isabel Rife, Project Director/Wellness Coordinator, Project Launch; Joane Nelson, Director; and Trinette Brewer, EC and Youth Development Specialist, Child Care Aware of Central Missouri; Rachel Kryah, Project Director; and Wendy Ell, Occupational Therapist, Missouri Institute of Mental Health

1D: Recognition at High School (*Crystal Ballroom*)

Excelsior Springs High School will share how they helped staff understand the power and use of positive feedback to encourage expected behaviors at a high rate (4:1) in all settings. Learn strategies to encourage appropriate behavior. Data, such as ODR, attendance, tardies, etc., will be shared to demonstrate the impact of their work.

Tier 1 – Foundation

Presenters: Marla Berry, Interventionist; Christen Everett, Teacher; Stacie Syler, Assistant Principal; and Katrina Yoakum, Teacher, Excelsior Springs High School, Excelsior Springs 40 School District

1E: Overview of SW-PBS (*Redbud*)

This session is designed for administrators, coaches and team members who are new to MO SW-PBS and will provide an overview of the essential components of SW-PBS: common philosophy and purpose, leadership, clarifying expected behavior, teaching expected behavior, encouraging expected behavior, discouraging inappropriate behavior, ongoing monitoring and classroom effective practices.

Tier 1 – Foundation

Presenters: Beverly Khozadi, MO SW-PBS Consultant, Central Region, University of Central Missouri; and Jill Miller, MO SW-PBS Consultant, Northeast Region, Truman State University

1F: A District Model for Integrated RtI Systems (*Salon A*)

Discover one district's efforts to strengthen an integrated tiered system of support addressing academic and social competencies. Session leaders will emphasize infrastructure development and efforts in progress for durable implementation and improved outcomes. This session is for educators in elementary schools who are beginning to implement a multi-tiered system of support or working to fully integrate both academic and social competency systems.

Tiers 1-3 – Enrichment

Presenter: Dr. Dawn Miller, Innovative Projects Facilitator, Shawnee Mission Public Schools, Shawnee Mission, Kan.

1G: Use of Screening Instruments to Identify Students At-Risk (*Northwinds*)

This session provides implementation examples for use of a systematic screening process to identify students with social, emotional and behavioral risk. Two schools will describe their process for screening all students and how results are used for selecting interventions.

Tiers 1-3 – Application

Presenters: Dr. Barbara Mitchell, Tier 2/3 Consultant, MO SW-PBS; Amber Crane, Principal; Robyn Jennings, Counselor; and Angie Morris, Teacher, Van Far Elementary, Van Far R-I School District; and Lucinda Varner, Assistant Principal; Randy Sweatt, Counselor; Kathleen Henson; Vickie Vest and Penny Rassler, Teachers, Hawthorn Elementary, Camdenton R-III School District

1H: Self-Monitoring (*Parasol I*)

Implementing self-monitoring from Tier 1 through Tier 3.

Tiers 1-3 – Application

Presenter: Dr. Deb Childs, Tier 2/3 Consultant, MO SW-PBS

1I: Leadership Overcomes Barriers (*Rooms 62-64*)

Change is never easy...especially at a middle school! Learn how the team at Raytown Middle School, with the support of administration, continues to meet the challenges of creating a positive and effective learning environment with predictable structures and practices for students and staff!

Tier 1 – Foundation

Presenters: Dr. Georgetta May, Principal; Dona Gibbons, Assistant Principal; Sheryl Jones, Interventionist; Leslie Cole and Dawn Prosser, Teachers; and Cynthia Gerdes, Counselor, Raytown Middle School, Raytown C-2 School District

BREAKOUT SESSION 2

June 12 • 4:00 – 5:15 p.m.

2A: Collaborative Teaming: How to Align Work Across Initiatives (*Salon A*)

Westview Elementary School will share their work in aligning initiatives such as PLC, PBIS, RtI and data teams across the three-tiered model. The team will also share strategies for sustaining their efforts across multiple years of implementation.

Tiers 1-3 – Application

Presenters: Rita Linhart, Principal; Amy Olinger, Title 1 Instruction; Reecie Hale and Jennifer Howerton, Teachers, Westview Elementary, Excelsior Springs 40 School District

2B: Creative Teaching Ideas – Elementary (*Salon C*)

Discover how this elementary school got creative when writing and teaching schoolwide, non-classroom and classroom expectations, rules and procedures. Learn about their school-year plan for the ongoing teaching of all expectations and rules.

Tier 1 – Foundation

Presenters: Angella Taylor, Counselor; Megan Shoemaker and Cheri Vanderpool, Teachers, Walt Disney Elementary, Marceline R-V School District

2C: From Pre-Service to Practice: What Every Preschool Teacher Needs to Know (*Parasol II*)

Dr. Beckner has identified key skills for teaching social behaviors that every early childhood instructor should not only know, but know how to successfully implement in the classroom. Discover these “lessons learned” as well as a general overview of key social behavioral teaching skills and how to employ them.

Tier 1 – Foundation

Presenter: Dr. Becky Beckner, Associate Professor, Early Childhood Education, Iowa Wesleyan College

2D: Fly Like an Eagle: The Student Voice of Ruskin High School (*Parasol I*)

Creating a school culture that fosters respect and responsibility requires participation from all of its stakeholders – including the students. Our PBIS student panel representatives will share their strategies to improve student academic success and increase faculty expectations. PBIS committee members will share their journey of transforming the culture of an urban high school.

Tier 1 – Foundation

Presenters: Chad Ryerson, Principal; Terri L. Redden, Teacher and PBIS Chair; June Hollowell-Ross, Teacher and PBIS Co-Chair; Kelly Kreisel, Teacher and PBIS Recorder; Dominique Basuby, Malik Barbour, Jarrett Bell, Kiestan Burrell, Alisha Hollister, Talia Nelson, Mikyla Rhodes, and Liliana Valenzuela, PBIS Student Panel Representatives, Ruskin High School, Hickman Mills C-1 School District

2E: PBS Down Under (*Redbud*)

Key to successful student outcomes is the adoption and adaptation of evidence-based practices within the SW-PBS framework. Learn how schools within New South Wales, Australia, applied the positive behaviour support process, and the impact it has had on students and schools (preschool through high school). Innovative practices supporting student voice will be shared.

Tier 1 – Foundation

Presenter: Jill Schofield, Positive Behaviour for Learning Coordinator, New South Wales Department of Education and Communities, New South Wales, Australia

2F: PBS 101 (*Crystal Ballroom*)

Saeger Middle School will share data on a strategy developed to provide students with additional practice on Tier 1 expectations. PBS 101 is used as a preventive measure with students who are approaching their Tier 2 data-decision rules.

Tiers 1-2 – Application

Presenters: Suzan Wilson, Pam Rodriguez, Angeline O’Neal and Stepanie Blakely, Teachers; and Jennifer Jorel, Reading Specialist, SW-PBS Coach and Tier 2/3 Facilitator, Saeger Middle School, Francis Howell R-III School District

2G: Implementation of Functional Behavioral Assessments (FBA) in School Settings (*Northwinds*)

Hear an overview of recommended steps for conducting FBA and learn how one junior high school team worked to develop a system for conducting FBA in their setting.

Tier 3 – Enrichment

Presenters: Dr. Barbara Mitchell, Tier 2/3 Consultant, MO SW-PBS; Roger Moore, Assistant Principal; Teresa King, Counselor; and Tiffany Piercy, Teacher, Lebanon Junior High School, Lebanon R-III School District; and Bobbie Russell, Principal; Janelle Stanek, Assistant Principal; Jenny Stanek, Jenny Westphal, Kelli Jasper and Megan Abramczyk, Teachers, Warrior Ridge Elementary, Warren County R-III School District

2H: Building a Tier 1 System in a Tier 3 School (*Rooms 62-64*)

Representatives from three different Colgan Center alternative programs (K-6 alternative program, 7-12 alternative program, and K-12 most-restrictive IEP environment) will provide an interactive session focusing on how to provide Tier 1 supports in Tier 3 environments. Learn how to differentiate PBIS Tier 1 structures to meet the needs of all at-risk students. Receive examples and templates used by the Colgan Center that can easily be adapted to meet the needs in participant classrooms and schools.

Tier 1 – Foundation

Presenters: Michele Thomason, Principal; Rachelle Keller, Adam Lewis, Steve Pierson and Ida Russell, Teachers, Colgan Alternative Resource Center, St. Joseph School District

BREAKOUT SESSION 3

June 13 • 9:15 – 10:30 a.m.

3A: District Leadership to Support Tiers 1-3 (*Parasol II*)

Research and experience tell us behavior and academic success are linked. We need to consider how to build a system to best insure the success of all students and to support those who struggle with one or both. Leaders from this exemplary school district will share how they have successfully integrated PLC/RTI/SW-PBS into an efficient and effective school improvement process that supports academic achievement for all.

Tiers 1-3 – Enrichment

Presenters: Dr. John Lacy, Superintendent; Dr. Karla Arnold, Assistant Superintendent of Student Services, Excelsior Springs 40 School District; Chris Hubbuch, Principal, Excelsior Springs Middle School; and Christie Rice, Principal, Lewis Elementary, Excelsior Springs 40 School District

3B: Managing Minor Misbehavior (*Salon A*)

Discover how this school taught staff to view social/behavioral errors as opportunities to re-teach the desirable behaviors, and how they led staff to determine what behaviors they manage and what behaviors are office-managed. Learn strategies to discourage minor inappropriate behavior and promote learning of appropriate replacement behaviors, and how staff use respectful responses that reduce the probability of escalating behavior.

Tier 1 – Foundation

Presenters: Ericka Dixon, Principal; Marissa Dodd, School Counselor; Amanda Brodbeck, Speech/Language Pathologist; Sheila Powers and Patricia Tippit-Weber, Teachers, Winfield Primary School, Winfield R-IV School District

3C: Using Data-Based Decision-Making at Quail Ridge Early Childhood Center (*Rooms 60-61*)

This session will highlight the purposes for data collection at the early childhood level. It will focus on the type of data that should be collected (major vs. minor infractions), using the Big 5 data for macro analysis of the building trends and use of data to make placement decisions, both internally to determine least restrictive environment, and externally to transition students to Kindergarten.

Tier 1 – Foundation

Presenter: Kevin Garcia, Principal, Quail Ridge Early Childhood Center, Wentzville R-IV School District

3D: Embedding Strategies to Address Bullying Within the SW-PBS Framework (*Suite G*)

Unfortunately bullying is a common problem found in all schools. This session will provide an overview of why students bully and evidence-based interventions to prevent and intervene. Particular emphasis will be placed on schoolwide systems to create safe learning environments. In this session, a middle school will share how their student forum has used a message of respect to promote bully prevention on their campus.

Tier 1 – Foundation

Presenters: Dr. Chris Templeton, Principal; Stephanie Roe, Counselor; and Kim Howard, Teacher, Reeds Spring Middle School, Reeds Spring R-IV School District; Dr. Tim Lewis, Director, MU Center for SW-PBS and Co-Director of PBIS National Center; and Betty Ennis, Tier 2/3 Consultant, MO SW-PBS

3E: Getting the Word Out: SW-PBS and Technology (*Crystal Ballroom*)

Schoolwide positive behavior support is an initiative that can support a positive culture in a building creating universal language and universal behavioral expectations. Use technology to help with the mission of getting the word out to staff, students, parents and community. We'll share ideas that we have used at Wyman Elementary School.

Tier 1 – Foundation

Presenters: Chris Wright, Teacher and Technology Coordinator; Katie Curtis and Gerry Brunton, Teachers; Julie Peterman, Counselor; and Susan Bowles, Principal, Wyman Elementary, Rolla 31 School District

3F: Multi-Tiered Systems of Support (*Parasol I*)

Learn the logic about “why” and “how” multi-tiered systems of support are composed of both academic and social behavioral components. Then see how this work unfolds in two Missouri elementary schools.

Tiers 1-3 – Enrichment

Presenters: Dr. Rebecca Holland, Site Coordinator, Missouri RtI Development, University of Central Missouri; Thea Scott, Director, Three-Tiered Model Coordination, Missouri Department of Elementary and Secondary Education; Hilary Bales, Principal, East Elementary; Mike Morriss, Principal; and Jim Robbins, Assistant Principal, Freedom Elementary, Waynesville R-VI School District

3G: Group-Based Interventions for Tier 2: An Overview of Research-Supported Practices (*Salon C*)

This session provides information about three research-based interventions school teams can develop and provide for students identified

for additional social, emotional or behavioral intervention. Learn how to determine which interventions are most appropriate for your students and school.

Tier 2 – Application

Presenter: Dr. Barbara Mitchell, Tier 2/3 Consultant, MO SW-PBS

3H: Tier 3 Systems (*Rooms 62-63*)

Learn about Tier 3 system features for core and action teams and how they have been implemented in a middle school.

Tier 3 – Enrichment

Presenters: Keelie Stucker, Assistant Principal; Molly Kuebler, Intervention Coach; and Val Staponski, Recovery Room Supervisor, Excelsior Springs Middle School, Excelsior Springs 40 School District; and Diane Feeley, Tier 2/3 Consultant, MO SW-PBS

3I: De-Escalation of Behavior (*Northwinds*)

This session will provide information about preventing and effectively responding to acting-out behaviors. Participants will:

- Identify seven phases of the acting-out cycle.
- Describe the different behaviors that make up each phase of the cycle.
- Identify possible interventions to use at each phase.

Tiers 1-3 – Application

Presenter: Dr. Terry Bigby, Tier 2/3 Consultant, MO SW-PBS

BREAKOUT SESSION 4

June 13 • 10:45 a.m. – 12:00 p.m.

4A: Successful Urban Leaders (*Rooms 60-61*)

Commitment from staff and administration makes SW-PBS happen at Santa Fe Elementary School, an urban school that is in the first year of implementation and is reaping results.

Tier 1 – Foundation

Presenters: Lynn Chase, Emily Hall, Heather McQueen and Amanda Russell, Teachers, Santa Fe Elementary, Hickman Mills C-1 School District

4B: Motivating the Whole School Using Contingencies and Rewards (*Salon A*)

Dr. Riffel will describe and provide multiple examples of three levels of contingencies and rewards that should be built into school and classroom management systems.

Tier 1 – Foundation

Presenter: Dr. Laura Riffel, Director, Behavior Doctor Seminars

4C: Tier 2 System of Support in Early Childhood

(Redbud)

Learn about intensive interventions implemented in an early childhood setting.

Tier 2 – Application

Presenters: Jennifer Meyer, Director; and Christy Snelling, Social Worker, Early Childhood Learning Center, Kirksville R-III School District

4D: The Nuts, Bolts, Cameras and Computers for Creating Homegrown Video: Guidelines and Tips for Creating Powerful Videos

(Northwinds)

Learn steps for producing videos that serve a specific purpose within your PBIS framework and that adhere to expected evidence-based standards and your school's unique needs.

Tier 1 – Foundation

Presenter: Dr. Michael Kennedy, Assistant Professor, Curry School of Education, University of Virginia

4E: Science of Behavior

(Parasol I)

Receive foundational information and definitions of the ABCs of behavior. An understanding of the ABCs will help teachers and administrators define behavior, create a behavioral summary statement to assist in determining the function of behavior and create an effective intervention plan.

Tier 1 – Foundation

Presenter: Linda Bradley, Research Assistant, MU Center for SW-PBS

4F: Newcomer's Club

(Crystal Ballroom)

This session will focus on a specific Tier 2 Intervention: Newcomer's Club. This intervention is connected to a comprehensive, integrated three-tiered system of prevention and intervention. The purpose of Newcomer's Club is to build a system to support new students to the school. The outcome is for new students to learn and be able to follow the schoolwide expectations, classroom expectations and routines, and to make friends. Critical features and school exemplars will be discussed and shared.

Tier 2 – Application

Presenter: Lisa Leonard, PBIS Facilitator, Special School District of St. Louis County

4G: Implementing the Check-in/Check-out Intervention in High School Settings

(Parasol II)

This session provides implementation examples from two SW-PBS teams that implemented the check-in/check-out intervention with high school students. Descriptions of the process and lessons learned that are specific to secondary level settings will be shared.

Tier 2 – Application

Presenters: Lynn Crader, Principal; Carolyn Pike and Kathy West, Teachers; Joanna Branson, Counselor; and Beverley Jenkins, Resource Staff, Sikeston R-6 Alternative Education Center, Sikeston R-6 School District; and Leah Stein, Principal; and Laura Moore, Teacher, Milan High School, Milan C-2 School District

4H: School Mental Health Within a Multi-tiered System of Behavioral Supports in Schools

(Salon C)

A framework to integrate mental health and other community partners through schoolwide PBIS structures will be described, including structures and processes to expedite outcomes for youth and families and progress/challenges experienced by implementation teams.

Tiers 1-3 – Enrichment

Presenter: Susan Barrett, Director, PBIS Regional Training and Technical Assistance Center, Sheppard Pratt Health System

BREAKOUT SESSION 5

June 13 • 1:45 – 3:00 p.m.

5A: PBIS District Leadership Teams: Using Implementation Science and the National Blueprint to Develop and Guide Implementation Efforts

(Rooms 60-61)

Learn how PBIS district leadership teams (DLT) might use implementation science and the National Blueprint to develop a 3-5 year action plan which supports schools to successfully implement, maintain and sustain PBIS. Discover the purpose and functions of a DLT, use of data, how a consultant supports this process and lessons learned from PBIS DLT coordinators. This session is recommended for those who might serve as a member on a DLT.

Tier 1 – Foundation

Presenters: Dr. Lisa Powers, Area Coordinator; Bridget Thomas, Counselor; and Lynn Yokoyama, PBIS Data Specialist, Special School District of St. Louis County

5B: Positive Interventions and Effective Strategies for the Classroom (Part 1)

(Salon A)

This session will highlight skills for basing interventions on the function of the behavior and maximizing research-based interventions that will work with many children in multiple settings. Part One will focus on the sensory needs of students with ADHD and Autism Spectrum Disorder. Part Two will focus on teaching strategies for struggling learners.

Tier 1 – Foundation

Presenter: Dr. Laura Riffel, Director, Behavior Doctor Seminars

5C: Involving Students in Schoolwide PBS: Adding the Student Voice to the Process and Outcomes

(Northwinds)

SW-PBS should be implemented **with** students not **to** students, yet their voice is often not heard in the process. Hear examples from both Missouri and Montana on how you can improve SW-PBS with your students' active support and increased ownership, and learn how to use technology to build enthusiasm and increase student involvement.

Tier 1 – Foundation

Presenters: Keith Hoyer, Teacher and Montana Behavior Initiative Consultant, Belt High School, Belt, Mont.; Dr. Tim Lewis, Director, MU Center for SW-PBS and Co-Director, PBIS National Center; and Blake Miller, Student, Missouri State University

5D: District Student-Data Systems and SW-PBS Data Reporting *(Rooms 62-63)*

Learn how Missouri SW-PBS administrators are using district student-data systems (SIS-Pulse, Lumens and Infinite Campus) to produce SW-PBS related data reports (e.g., Big 5 and student identification alerts for data-based decision-making).

Tier 1 – Foundation

Presenters: Bryan Campbell, Assistant Principal; Pam Gow, Teacher; and Lori Ranfeld, Counselor, Maplecrest Elementary, Lebanon R-III School District; Dawn Hellebusch, Principal; Debbie Brewer, Teacher; and Cheryl Spratt, Counselor, Clearview Elementary, Washington School District; and Stephanie Grisham, Teacher and A+ Director; Jamie Cantrell and Carol White, Teachers, Rolla High School, Rolla 31 School District

5E: Integrated Models: Big Ideas That Make Them Work *(Suite G)*

As the PBIS framework continues to develop and expand, the organizational features promote integration across disciplines and systems including social behavior, academics, mental health and juvenile justice. This session describes how integration is occurring and provides examples and sample implementation tools.

Tiers 1–3: Enrichment

Presenter: Susan Barrett, Director, PBIS Regional Training and Technical Assistance Center, Sheppard Pratt Health System

5F: Tier 2 Readiness *(Parasol I)*

An overview of Tier 2 support and the indicators for school readiness.

Tier 2 – Application

Presenter: Diane Feeley, Tier 2/3 Consultant, MO SW-PBS

5G: Small Group Social Skills *(Crystal Ballroom)*

Review of the main features of small group social skills intervention and learn how it has been implemented in two elementary school settings.

Tier 2 – Application

Presenters: Diana Ables, Rainah Pray, Sheryl Smallwood, Jennifer Read and Jill Wood, Teachers; and Kelly Pezzani, Counselor, Becky-David Elementary, Francis Howell R-III School District; and Cynthia Matthew, Principal; Donna Bullard, Social Worker; and Brandy Hepler, Teacher, West Lane Elementary, Jackson R-II School District

5H: Discovery Through Challenges: Positive Results for Students with Special Needs *(Parasol II)*

In this round table discussion, staff of Missouri Schools for the Severely Disabled (MSSD) will discuss the challenges they have faced and solutions they have developed for implementing SW-PBS. Some of the challenges MSSD faced were:

- Modifying teaching to ensure students with severe intellectual disabilities can understand and respond to SW-PBS expectations.
- Reporting discipline incidents in a meaningful way so data can be analyzed.
- Providing support to those who are working with students with significantly challenging behaviors (including physical).
- Developing strategies to provide information to families to help them use similar strategies in their homes.
- Discussing how to keep the momentum going after the first couple of years of SW-PBS.

After each short presentation there will be a question/answer period.

Tier 1 – Foundation

Presenters: Mary Jo Watkins and Janelle Burch, Supervisors for Instruction, Missouri Schools for the Severely Disabled; Debby Lucast, Building Administrator, Helen Davis State School, St. Joseph, Mo.; and Brenda McCowan, Building Administrator; and Kara Hech, Teacher, Parkview State School, Cape Girardeau, Mo.

5I: Capturing Student Voice in the Context of the School Day: A Unique Approach to a Common Problem *(Redbud)*

Learn how one middle school provided students with leadership experiences and opportunities for input into SW-PBS systems including student-made video lessons within the context of the school day.

Tier 1 – Foundation

Presenters: Dr. Randy Oliver, Assistant Principal; and Jeremy Bradham, Teacher, Antioch Middle School, North Kansas City 74 School District

BREAKOUT SESSION 6

June 13 • 3:15 – 4:30 p.m.

6A: PBIS District Leadership Teams: Building Capacity to Support Training and Coaching

(Rooms 60-61)

Learn how PBIS district leadership teams (DLT) might use implementation science and the National Blueprint to build capacity to support training and coaching for a tiered system of support, both academic and behavioral, throughout the district. Discussions will focus on Tier 2 and 3 interventions and include how to use these practices in your district. A district-wide data-tracking tool will be shared. This session is recommended for those who might serve as a member on a DLT (assistant superintendent, special education director, principal, professional development coordinator, etc.).

Tier 1 – Foundation

Presenters: Dr. Lisa Powers, Area Coordinator; Bridget Thomas, Counselor; and Lynn Yokoyama, PBIS Data Specialist, Special School District of St. Louis County

6B: Positive Interventions and Effective Strategies for the Classroom (Part 2)

(Salon A)

Learn skills for basing interventions on the function of the behavior and maximizing research-based interventions that will work with many children in multiple settings. Part One focused on the sensory needs of students with ADHD and Autism Spectrum Disorder. Part Two will focus on teaching strategies for struggling learners.

Tier 1 – Foundation

Presenter: Dr. Laura Riffel, Director, Behavior Doctor Seminars

6C: Team Process for All Members

(Parasol II)

This is an orientation session for new members of the SW-PBS leadership team. Festus Elementary will share how to have efficient and effective leadership team meetings including team member roles, agenda, norms or ground rules, how to determine consensus and the rotation of members. Learn how action planning is used to guide and review the team's work and tasks, and how they provide staff with professional development to ensure they have the knowledge and skills needed to implement successfully.

Tier 1 – Foundation

Presenters: Darin Siefert, Principal; Angela Myers, Counselor; Jennifer Granda, Meagan Wagner and Stephanie Sutton, Teachers, Festus Elementary, Festus R-VI School District

6D: Creative Teaching in High School

(Crystal Ballroom)

Staff from Milan High School will share how they created lessons and taught schoolwide, non-classroom and classroom expectations, rules and procedures. They will share their school-year plan for the ongoing teaching of all expectations and rules. Ideas on how to implement student involvement in the lesson creation and review process will be shared.

Tier 1 – Foundation

Presenters: Leah Stein, Principal; and Laura Moore, Teacher, Milan High School, Milan C-2 School District

6E: Enter the World of Social Media

(Parasol I)

Social media has transformed the world of your students and perhaps your classroom. How about your professional development and collaboration? Learn how to use tools like Twitter to become a connected educator and crowdsource ideas for PBIS. This session will also cover multiple tools that support Twitter and can be used for PD back at school. Participants are encouraged to bring their Smartphone, iPad or other tablet or laptop.

Tiers 1-3 – Application

Presenters: Chris Hubbuch, Principal; and Michelle Nebel, Teacher, Excelsior Springs Middle School, Excelsior Springs School District

6F: Using Data to Provide Feedback for Classroom-Level PBS Practices

(Suite G)

Learn about a pilot project in which the SW-PBS team of one elementary school developed a process for conducting classroom observations, collecting data and providing data-based feedback to teachers about their implementation of positive specific feedback, correctives and opportunities to respond.

Tier 1 – Application

Presenters: Tim Roth, Principal; Christie Lewis, Counselor; Callie Johnson, Erica Trusty and Kim Dickinson, Teachers, South Park Elementary, Moberly School District; and Dr. Barbara Mitchell, Tier 2/3 Consultant, MO SW-PBS

6G: Staying on Course: Progress Monitoring to Insure Success

(Northwinds)

An integral part of the SW-PBS problem-solving process is using data to match intervention to the presenting problem as well as using data to determine success. Discover strategies to monitor progress of both student social behavior outcomes and educator implementation across the continuum.

Tiers 1-3 – Application

Presenter: Dr. Tim Lewis, Director, MU Center for SW-PBS and Co-Director, PBIS National Center

6H: Expanding the Triangle: Tiered Supports Model Moves to the Developmental Disabilities

Community and Beyond (*Redbud*)

Missouri's statewide team is building cross-agency collaboration using PBIS training materials and systems at local and regional levels. Learn how tiered systems are being implemented across agencies in the developmental disability systems.

Tiers 1-3 – Foundation

Presenters: Dr. Rachel Freeman, Director, Kansas Institute of Positive Behavior Support; Julia LePage, Director, Community Supports Unit; and Dr. Terri Rogers, Chief Behavior Analyst, Division of Developmental Disabilities, Missouri Department of Mental Health; Terri Werner, Supervisor; and Pat Connors, Behavior Resource Team Member, Rolla Resource Team; and Carol Snow, Executive Director; Vickie Jones, Supervisor; Linda Knowles and Georgette Makras, Secretaries, FutureCare Inc.

BREAKOUT SESSION 7

June 14 • 8:15 – 9:30 a.m.

7A: Marzano to Go (Part 1) (*Crystal Ballroom*)

A large part of managing positive classrooms is giving kids many different opportunities and ways to respond to and process information. Learn strategies that lead to effective learning as originally outlined by Dr. Robert Marzano.

Tier 1 – Foundation

Presenter: Travis Dimmit, Principal, North Nodaway Junior/Senior High School, North Nodaway R-IV School District

7B: Family – Community – School: Creating a Partnership for Success (*Northwinds*)

Research indicates that creating a partnership between families, communities and schools benefits all stakeholders and has a direct link to increasing student success. Learn how to identify and overcome challenges to developing these connections within your school and hear how several schools have put systems in place to create successful partnerships.

Tier 1 – Foundation

Presenters: Susanna Hill, Tier 2/3 Consultant, MO SW-PBS; Rick Talbott, Assistant Principal; Lebanon High School; Rachele Jennings, Assistant Principal, Boswell Elementary; Bob Matthews, Special Education Coordinator; Lebanon R-III School District; John Collins, Principal; Raymondville Elementary, Raymondville R-VII School District; and Shanna Weber, Director of Special Services, Winfield R-VI School District

7C: Taste of Mental Health First Aid (*Parasol II*)

This workshop gives participants a “taste” of Mental Health First Aid (MHFA). MHFA is an evidence-based public education program that is widely available across the US. The goal of the MHFA program is to help the public identify, understand and respond to signs of mental illnesses and substance use disorders. Receive information regarding access to more extensive training opportunities in your community.

Tiers 2-3 – Enrichment

Presenter: Rita McElhany, Coordinator of Mental Health Promotion, Division of Behavioral Health, Missouri Department of Mental Health

7D: 21st Century Skills and the iPad – What’s the Connection? How to Support Creativity, Collaboration and Engagement with iPads (*Salon C*)

Learn to use the iPad as a classroom tool to offer choice and give opportunities to respond, and to increase positive interactions with students instead of just a device for checking e-mail and surfing the net. Discover features of the iPad, rubrics for selecting applications and ideas that support our 21st Century learners.

Tier 1 – Foundation

Presenters: Diane Grep, Technology Director; and Jo Ann Anderson, SW-PBS Consultant, South Central RPDC, Missouri University of Science and Technology

7E: Blending Academic and Behavioral Supports Through the Tier 2 Process (*Salon A*)

Addressing necessary social and academic supports is essential in the SW-PBS process to increase the likelihood that all students are successful. Discover universal classroom supports and learn how to focus on incorporating academic accommodations within the Tier 2 process for at-risk students.

Tier 2 – Application

Presenter: Dr. Tim Lewis, Director, MU Center for SW-PBS and Co-Director, PBIS National Center

7F: Tier 2 Data (*Redbud*)

This session will focus on the use of Tier 2 data tools such as BAT, and Advanced and Tiers Spreadsheets, to support Tier 2 implementation and decision-making.

Tier 2 – Application

Presenters: Betty Ennis and Diane Feeley, Tier 2/3 Consultants, MO SW-PBS

7G: Behavior Intervention Plans (Part 1): Developing A Competing Behavior Pathway (*Suite G*)

Participants will work with a case study to develop a competing behavior pathway.

Tier 3 – Enrichment

Presenter: Dr. Terry Bigby, Tier 2/3 Consultant, MO SW-PBS

BREAKOUT SESSION 8

June 14 • 9:45 – 11:00 a.m.

8A: Marzano to Go (Part 2) (*Crystal Ballroom*)

A large part of managing positive classrooms is giving kids many different opportunities and ways to respond to and process information. In this workshop, the presenter will break down and model strategies that lead to effective learning as originally outlined by Dr. Robert Marzano.

Tier 1 – Foundation

Presenter: Travis Dimmit, Principal, North Nodaway Junior/Senior High School, North Nodaway R-IV School District

8B: First Step to Success: An Intervention for Young Children with Problem Behavior (*Salon A*)

Learn about First Step to Success, an early-intervention program designed for young children (K-2) who show early signs of antisocial, acting-out behavior. The program incorporates adult praise and feedback, positive reinforcement, social skills training, teacher and parent involvement, and a timeout/cost contingency. It also includes techniques to promote generalization of behavior change across the school day and in the home.

Tier 2 – Application

Presenter: Dr. Barbara Mitchell, Tier 2/3 Consultant, MO SW-PBS

8C: A Window into Their World: Supporting Missouri's Youth in Juvenile Justice (*Parasol I*)

Receive an overview of the juvenile justice system in Missouri and suggestions on how local schools can support success for students returning to their home communities. Questions and discussion are strongly encouraged.

Tiers 1-3 – Enrichment

Presenter: D. Tichelle Bruntmyer, Doctoral Student, Department of Special Education, University of Missouri-Columbia

8D: SW-PBS Data Tools (*Rooms 62-63*)

See a demonstration of the Big 5 Generator (including EC version) data collection tool (individual student data) and data decision-making. For this hands-on session, **a computer and download tools are required.**

Tier 1 – Foundation

Presenter: Gordon Way, MO SW-PBS Consultant, Kansas City Region, University of Missouri-Kansas City

8E: Preventing Bullying at Sunshine Elementary (*Salon B*)

SW-PBS systems give students the tools to reduce bullying behavior through the blending of schoolwide positive behavior support, explicit instruction and a definition of the bullying construct through six already developed lessons. Participants will view the materials and presentation used at Sunshine Elementary.

Tier 1 – Foundation

Presenters: René Saner, Principal; Rick Greiner, Counselor; Mary Downing and Kim Strubberg, Teachers, Sunshine Elementary; and Lora Hopper, Principal, Portland Elementary, Springfield R-XII School District

8F: Organization Skills (*Salon C*)

Implementing organizational skills from Tier 1 through Tier 3.

Tiers 1-3 – Application

Presenters: Dr. Deb Childs, Tier 2/3 Consultant, MO SW-PBS; and Karen Westhoff, MO SW-PBS Consultant, St. Louis RPDC and Cooperating School Districts

8G: Behavior Intervention Plans (Part 2): Creating Clear and Measurable Goals (*Suite G*)

Participants will develop specific, observable and measurable goals for behaviors identified in the competing behavior pathway.

Tier 3 – Enrichment

Presenter: Dr. Terry Bigby, Tier 2/3 Consultant, MO SW-PBS

8H: School Counselors and SW-PBS: A Perfect Blend! (*Parasol II*)

If you are a professional school counselor, this session is for you! Join the MO SW-PBS guidance and counseling committee for a session focused exclusively on your integrated role as a SW-PBS team member and professional school counselor. Information will be provided as well as networking time to receive ideas from other school counselors!

Tiers 1-3 – Foundation

Presenters: Megan Freeman, Assistant Director, Effective Practices, Missouri Department of Elementary and Secondary Education; Jo Ann Anderson, MO SW-PBS Consultant, South Central RPDC, Missouri University of Science and Technology; Betty Ennis and Susanna Hill, Tier 2/3 Consultants, MO SW-PBS; and Danielle Starkey, MO SW-PBS Consultant, Heart of Missouri RPDC

SCHOOL RECOGNITION AWARDS

GOLD

Bayless

Bayless Elementary

Carl Junction R-I

Carl Junction Primary K-1

Excelsior Springs

Excelsior Middle
Lewis Elementary
Westview Elementary

Ferguson Florissant R-II

Central Elementary
Halls Ferry Elementary

Francis Howell R-III

Becky-David Elementary
Hollenbeck Middle
Saeger Middle

Fredericktown R-I

Fredericktown Intermediate

Golden City R-III

Golden City Elementary

Hancock Place

Hancock Place Middle

Jackson R-II

West Lane Elementary

Joplin R-VIII

Joplin Beacon

Kirkville R-III

Kirkville Preschool
Kirkville Primary

Kirkwood R-VII

Kirkwood Early Childhood Center
Westchester Elementary

Lebanon R-III

Boswell Elementary
Lebanon High

Marceline R-V

Walt Disney Elementary

Marshfield R-I

Daniel Webster Elementary

Mehlville R-IX

John Cary Early Childhood Center
Oakville Middle

Moberly

Gratz Brown Elementary

Mountain Grove R-III

Mountain Grove Elementary

Parkway C-2

Shenandoah Valley Elementary

Reeds Spring R-IV

Reeds Spring Middle

Ritenour

Marvin Elementary

Rockwood R-VI

Rockwood Early Childhood Center

Rolla 31

Wyman Elementary

Special School District of St. Louis County

Hiram Neuwoehner

Springfield R-VII

Portland Elementary
Sunshine Elementary

Strafford R-VI

Strafford Elementary

Waynesville R-VI

Partridge Elementary

Windsor C-1

Windsor Elementary

SILVER

Camdenton R-III

Hawthorn Elementary

Dexter R-XI

Southwest Elementary

Dixon R-I

Dixon Elementary

Excelsior Springs

Elkhorn Elementary

Ferguson Florissant R-II

Combs Elementary
Cross Keys Middle
McCluer High
Wedgwood Elementary

Fredericktown R-I

Fredericktown Elementary

Fulton 58

Bartley Elementary
Bush Elementary
McIntire Elementary

Hannibal 60

Mark Twain Elementary

Hazelwood

Hazelwood Early Childhood
Education Centers
Hazelwood North Middle
Jamestown Elementary
Jana Elementary
Keevan Elementary
Lawson Elementary

Joplin R-VIII

McKinley Elementary

Kingston K-14

Kingston Elementary
Kingston High
Kingston Middle

Kirkville R-III

Ray Miller Elementary

Laclede County R-I

Conway Ezard Elementary

Lebanon R-III

Esther Elementary
Hillcrest Elementary
Lebanon Junior High
Maplecrest Elementary

Marshfield R-I

Hubble Elementary

Milan C-2

Milan Elementary

Moberly

North Park Elementary
South Park Elementary

Montgomery County R-II

Jonesburg Elementary
Montgomery City Elementary
Montgomery Middle

Nixa R-II

Mathews Elementary
Summit Intermediate

North Kansas City 74

Davidson Elementary
Eastgate Middle
Gashland Elementary
Maple Park Middle
Maplewood Elementary
West Englewood Elementary

Ozark R-VI

East Elementary
North Elementary

SCHOOL RECOGNITION AWARDS

Park Hill

Renner Elementary

Parkway C-2

Mason Ridge Elementary

Pierce City R-VI

Central Elementary

Raymondville R-VII

Raymondville Elementary

Reeds Spring R-IV

Reeds Spring High

Ritenour

Iveland Elementary

Kratz Elementary

Ritenour Middle

Rolla 31

Rolla Senior High

Sikeston R-6

Sikeston 5th & 6th Grade Center

Sikeston Alternative School

Southern Boone County R-I

Southern Boone K-2 Primary

Southern Boone Middle

Southwest R-V

Southwest Elementary

Southwest Middle

St. Clair R-XIII

Edgar Murray Elementary

Strafford R-VI

Strafford High

Strafford Middle

Van-Far R-I

Van-Far Elementary

Walnut Grove R-V

Walnut Grove Elementary

Warren County R-III

Daniel Boone Elementary

Rebecca Boone Elementary

Warrior Ridge Elementary

Waynesville R-VI

East Elementary

Freedom Elementary

Thayer Elementary

Wood Elementary

Winfield R-IV

Winfield Intermediate

Winfield Middle

Winfield Primary

BRONZE

Adair County R-I

Adair County Elementary

Adair County High

Hannibal 60

A.D. Stowell Elementary

Eugene Field Elementary

Knox County R-I

Knox County Elementary

Lewis County C-1

Highland Elementary

Milan C-2

Milan High

Milan Middle

Schuyler County R-I

Schuyler County Elementary

Belton 124

Mill Creek Upper Elementary

Bolivar R-I

Bolivar Intermediate

Branson R-IV

Branson Intermediate

Branson Primary

Calhoun R-III

Calhoun Elementary

Calhoun High

Cape Girardeau 63

Clippard Elementary

Franklin Elementary

Carl Junction R-I

Carl Junction Intermediate

Carl Junction Primary 2-3

Carrollton R-II

Carrollton Middle

Chaffee R-II

Chaffee Elementary

Clinton County R-III

Ellis Elementary

Columbia 93

Early Childhood Center

Community R-VI

Community Elementary

Concordia R-II

Concordia Elementary

Confluence Academies

Old North

South City

Walnut Park K-8

Crawford County R-I

Bourbon Elementary

Bourbon Middle

Cuba Middle

Crocker R-II

Crocker High

Crystal City 47

Crystal Elementary

Dent-Phelps R-III

Dent-Phelps Elementary

Desoto

Athena Elementary

Dixon R-I

Dixon Middle

Doniphan R-I

Doniphan Middle

East Carter County R-II

East Carter County R-II Middle

El Dorado Springs R-II

El Dorado Springs Elementary

Excelsior Springs 40

Excelsior Springs High School

Ferguson Florissant R-II

McCluer South-Berkeley High

Vogt Elementary

Festus R-VI

Festus Elementary

Francis Howell R-III

Central Elementary

Daniel Boone Elementary

Henderson Elementary

Warren Elementary

Fulton 58

Fulton Middle

Genesis School Inc.

Genesis School

Golden City R-III

Golden City High

SCHOOL RECOGNITION AWARDS

Bronze (Continued)

Hazelwood

Arrowpoint Elementary
Barrington Elementary
Brown Elementary
Garrett Elementary
McNair Elementary

Hickman Mills C-1

Ruskin Heights High
Santa Fe Trails Elementary

Hillsboro R-III

Hillsboro Elementary

Humansville R-IV

Humansville Elementary

Jackson R-II

Millersville Attendance Center
South Elementary

Jasper County R-V

Jasper County Elementary
Jasper County High

Jefferson City

Belair Elementary

Joplin R-VIII

Cecil Floyd Elementary
East Middle
Emerson Elementary

Kansas City 33

Attucks Elementary
Garfield Elementary
J. A. Rogers Elementary
John T. Hartman Elementary
Wendell Phillips Elementary

Kingston 42

Kingston Primary

Kirkwood R-VII

North Kirkwood Middle

Marshfield R-I

Shook Elementary

Mehlville R-IX

Beasley Elementary
Bernard Middle
Blades Elementary
Forder Elementary
Margaret Buerkle Middle
Oakville Elementary
Point Elementary
Washington Middle
Wohlwend Elementary

Meramec Valley R-III

Coleman Elementary
Meramec Valley Middle
Truman Elementary
Zitzman Elementary

Mexico 59

Hawthorne Elementary
Mexico High

Midway R-I

Midway Elementary

Moberly

North Central Regional Middle/
North Central Regional

Monett R-I

Monett Elementary

Missouri Schools for the Severely Disabled

Helen Davis State School
B. W. Sheperd State School

Nell Holcomb R-IV

Nell Holcomb Elementary

Neosho R-V

Benton Elementary
Carver Elementary
Field Early Childhood Center
Goodman Elementary
Neosho Junior High

Nixa R-II

Century Elementary
Inman Intermediate

North Callaway R-I

Williamsburg Elementary

North Kansas City 74

Antioch Middle
Clardy Elementary
Northgate Middle
Oak Park High

North St. Francis County R-I

North County Middle
Parkside Elementary

Northeast Randolph County R-IV

Northeast Elementary

Ozark R-VI

South Elementary
Upper Elementary
West Elementary

Pathway Academy

Pathway Academy Elementary

Pattonville R-III

Holman Middle
Parkwood Elementary
Traditional School

Perry County 32

Perryville Elementary
Perryville Senior High

Phelps County R-III

Phelps County Elementary

Poplar Bluff R-I

Lake Road Elementary

Raytown C-2

Blue Ridge Elementary
Eastwood Hills Elementary
Fleetridge Elementary
Laurel Hills Elementary
Little Blue Elementary
New Trails Elementary
Norfleet Elementary
Raytown Education Center
Raytown High
Raytown Middle
Raytown South High
Raytown South Middle
Robinson Elementary
Southwood Elementary
Spring Valley Elementary
Westridge Elementary

Rolla 31

Rolla Junior High

Salem R-80

Salem Junior High
Salem Upper Elementary
William Lynch Elementary

School of the Osage R-II

Leland O. Mills Elementary
Osage Upper Elementary

Sedalia 200

Sedalia Middle

Sikeston R-6

Sikeston 7th & 8th Grade Center

Skyline R-II

Skyline Elementary

Southern Boone County R-I

Southern Boone Elementary
Southern Boone High School

Southern Reynolds County R-II

Ellington Elementary

SCHOOL RECOGNITION AWARDS

Special School District of St. Louis County
Southview

St. Louis City
Hamilton Elementary
Sigel Elementary
Woerner Elementary

St. Clair R-XIII
St. Clair Elementary

St. James R-I
Lucy Wortham James Elementary

St. Joseph
Coleman Elementary
Colgan Alt. Resource Center
Pickett Elementary

Steelville R-III
Steelville Middle

Sunrise R-IX
Sunrise Elementary

Tri-County R-VII
Tri-County Elementary

Troy R-III
Ninth Grade Center
Troy Middle

University City
Pershing Elementary

Washington
Clearview Elementary
Marthasville Elementary
South Point Elementary

Waynesville R-VI
Waynesville 6th Grade Center

Webb City R-VII
Bess Truman Primary Center
Carterville Elementary
Eugene Field Elementary
Harry S Truman Elementary
Madge T. James Kindergarten Center
Mark Twain Elementary
Webb City High
Webb City Junior High
Webb City Middle
Webster Primary Center

Webster Groves
Bristol Elementary
Hudson Elementary

Wentzville R-IV
Discovery Ridge Elementary
Duello Elementary
Green Tree Elementary
Heritage Intermediate
Heritage Primary
Peine Ridge Elementary
Prairie View Elementary
Early Childhood Center

West Nodaway County R-I
West Nodaway Elementary

West Plains R-VII
West Plains Elementary

Westran R-I
Westran Elementary
Westran High
Westran Middle

Wheaton R-III
Wheaton Elementary

Willow Springs R-IV
Willow Springs Elementary

Windsor C-1
Freer Elementary

Winfield R-IV
Winfield High

PAY IT
FORWARD
WITH SW-PBS FOR SCHOOL SUCCESS



MO SW-PBS TEAM

STATE PERSONNEL

Mary Richter*

State Coordinator
573-882-1197
millerrichterm@missouri.edu

Tim Lewis*

MU SW-PBS Center Director
573-882-9644
lewistj@missouri.edu

Nanci Johnson*

Data/Web Consultant
573-882-1197
johnsonnw@missouri.edu

TIER 2/TIER 3 CONSULTANTS

Terry Bigby

913-334-4594
bigbyt@missouri.edu

Deb Childs

636-373-1533
childsde@missouri.edu

Betty Ennis

417-763-0979
ennisb@missouri.edu

Diane Feeley

913-633-9109
feeleyd@umkc.edu

Susanna Hill

417-268-7990
hillsj@missouri.edu

Barbara Mitchell

573-882-1197
mitchellbs@missouri.edu

REGIONAL CONSULTANTS

Beverly Kohzadi

Central RPDC
800-762-4146
kohzadi@ucmo.edu

Robert Rethemeyer

Central RPDC
800-762-4146
rethemeyer@ucmo.edu

Amanda Holloway

Heart of Missouri RPDC
573-882-5763
hollowayal@missouri.edu

Danielle Starkey

Heart of Missouri RPDC
573-884-7089
starkeyd@missouri.edu

Phyllis Budesheim

Kansas City RPDC
816-235-6130
budesheim@umkc.edu

Gayle Hurst

Kansas City RPDC
816-235-1879
hurstg@umkc.edu

Margie Shean

Kansas City RPDC
816-235-5667
sheanm@umkc.edu

Gordon Way

Kansas City RPDC
816-235-5656
wayg@umkc.edu

Jill Miller

Northeast RPDC
660-785-7827
jillmiller@truman.edu

Karen Wigger

Northwest RPDC
660-562-1995
kwigger@nwmissouri.edu

Jo Ann Anderson

South Central RPDC
573-341-4153
joann@mst.edu

Janet Crafton

South Central RPDC
573-341-6258
jcrafton@mst.edu

Heather Herweck-Luckner

South Central RPDC
573-341-7862
herweckh@mst.edu

Tom Anderson

Southeast RPDC
573-651-2730
tanderson@semo.edu

Debora (Debbie) Lintner

Southeast RPDC
573-986-6193
dlintner@semo.edu

Roger Chasteen

Southwest RPDC
417-836-4079
rogerchasteen@missouristate.edu

Jane Medlen

Southwest RPDC
417-836-4074
janemedlen@missouristate.edu

Kelley Ritter

Southwest RPDC
417-836-4074
kritter@missouristate.edu

Drew Schwartz

St. Louis RPDC
314-692-1248
dschwartz@csd.org

Karen Westhoff

St. Louis RPDC
314-692-1252
kwesthoff@csd.org

DESE PERSONNEL

Megan Freeman*

Effective Practices Assistant Director
573-751-2512
megan.freeman@dese.mo.gov

Pam Williams*

Special Education Coordinator
573-751-0699
pam.williams@dese.mo.gov

Ginger Henry*

Effective Practices Director
573-751-0625
ginger.henry@dese.mo.gov

MU SW-PBS CENTER PERSONNEL

Linda Bradley

Research Assistant
573-882-1197
bradleyl@missouri.edu

Sarah Moore

Research Assistant
573-882-1197
mooresarah@missouri.edu

***State Leadership Team**

FACILITY LAYOUT



BUILDING A & B
(Meeting and Facilities Directional Map)

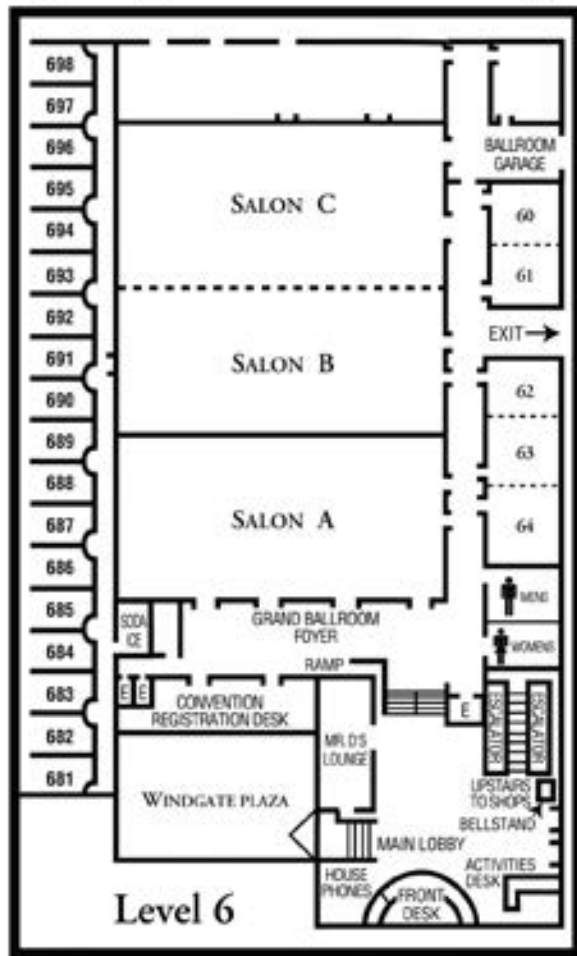

CRYSTAL BALLROOM: Go down Market Lane, past all shops, down three flights of stairs, to our Social Lobby. At the Social Lobby take the short flight of carpeted steps up to the Crystal Ballroom, which is on your left.

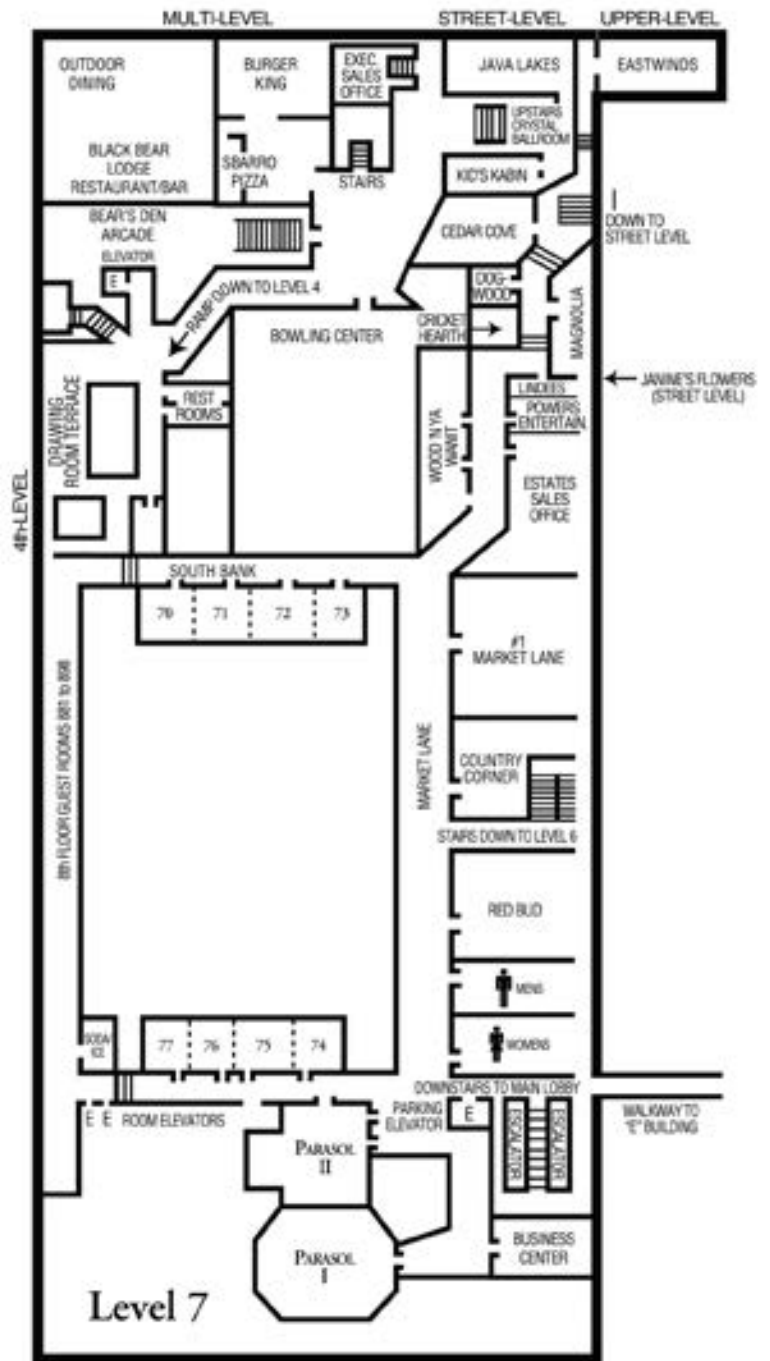

NORTHWINDS AND SUITE G: Take escalator or elevator from the Main Lobby up to the catwalk to Building E. Cross the catwalk to the 3rd level of Building E. Go left at Building E's main corridor and proceed out the side door into the stairwell where you will exit through the door on your left. Go across the road and into Building D, entering through the double glass doors on your left. Northwinds and Suite G are in Building D, next door to each other.

MISSOURI COUNTIES WITH SCHOOLS IMPLEMENTING SCHOOLWIDE POSITIVE BEHAVIOR SUPPORT 2012-2013

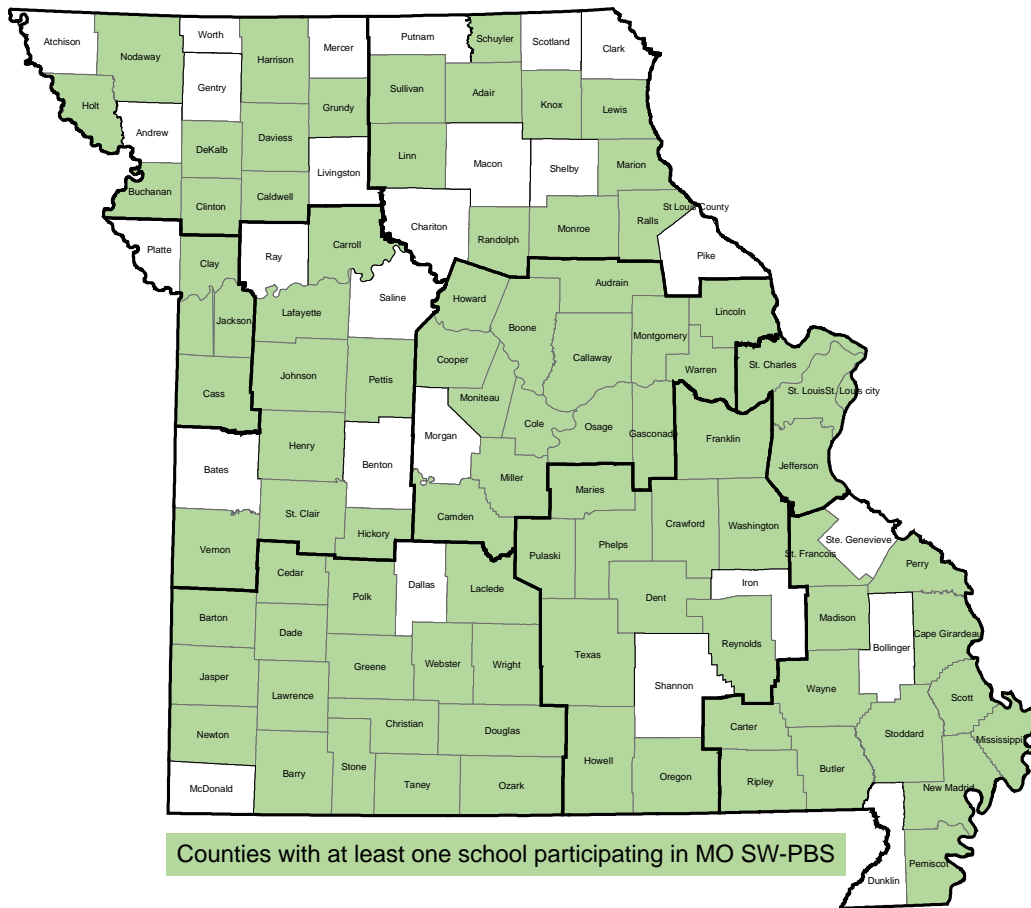

**PAY IT
FORWARD**
WITH SW-PBS FOR SCHOOL SUCCESS

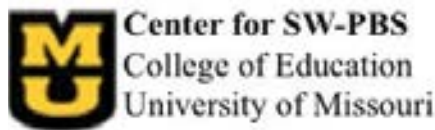

The Department of Elementary and Secondary Education does not discriminate on the basis of race, color, religion, gender, national origin, age, or disability in its programs and activities. Inquiries related to Department programs and to the location of services, activities, and facilities that are accessible by persons with disabilities may be directed to the Jefferson State Office Building, Office of the General Counsel, Coordinator, Civil Rights Compliance (Title VI/Title IX/504/ADA/Age Act), 6th Floor, 205 Jefferson Street, P.O. Box 480, Jefferson City, MO 65102-0480; telephone number 573-526-4757 or TTY 800-735-2966; fax number 573-522-4883; email civilrights@dese.mo.gov.